



# RAZER CHROMA LIGHT STRIP SET

MASTER GUIDE

Immerse yourself in the full Razer Chroma™ RGB experience anywhere with the **Razer Chroma Light Strip Set**. With the help of a controller powered by Razer HyperSpeed Wireless, sync your setup instantly as you enjoy gaming in a whole new light.

## CONTENTS

1. WHAT'S INSIDE / WHAT'S NEEDED .....	3
2. LET'S GET YOU COVERED .....	5
3. TECHNICAL SPECIFICATIONS .....	6
4. GETTING STARTED.....	7
5. USING THE ARGB CONTROLLER .....	13
6. CONFIGURING YOUR RAZER CHROMA WIRELESS ARGB CONTROLLER.....	15
7. SAFETY AND MAINTENANCE .....	26
8. LEGALESE.....	27

---

## 1. WHAT'S INSIDE / WHAT'S NEEDED

### WHAT'S INSIDE

- Razer Chroma Wireless ARGB Controller

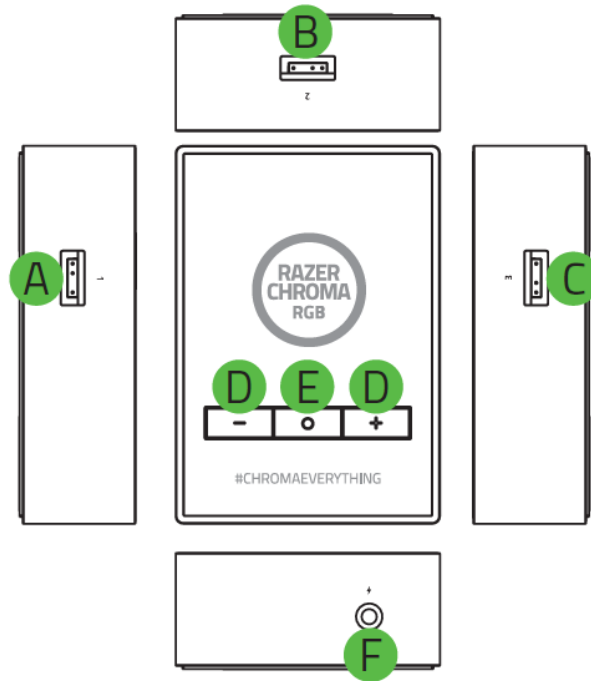

- A. 3-pin 5V port (Port 3)
- B. 3-pin 5V port (Port 2)
- C. 3-pin 5V port (Port 1)
- D. Brightness control buttons
- E. Power button
- F. Power port

**i** Power output from a single LED channel port is 5V 4.5A. Total power from all three LED channel ports is 5V 9A.

- Wireless USB transceiver

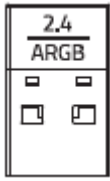

- Power adapter with interchangeable AC plugs\*

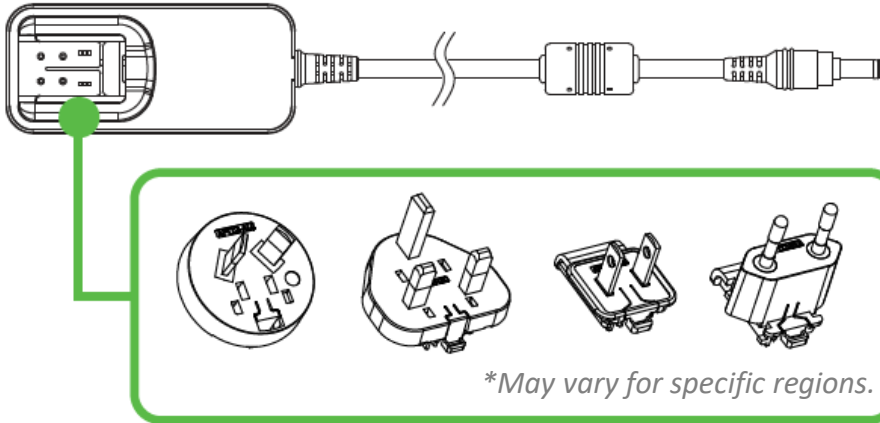

- 3 x Controller to LED strip connector cables



- 1 x 100 cm LED strip

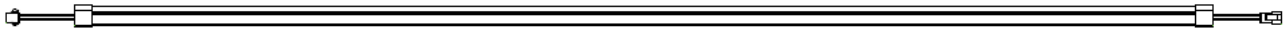

- 2 x 50 cm LED strips



- 2 x Double-sided adhesive tapes

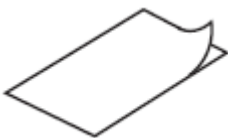

- 15 x Mounting brackets

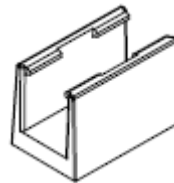

- 3 x LED Strip protector clips

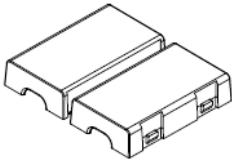

- 15 x Bracket adhesive tapes



- Important Product Information Guide

## WHAT'S NEEDED

### Product requirements

- USB-A port or Bluetooth 5.1 connectivity

### Razer Synapse requirements

- Windows® 8 64-bit (or higher)
- Internet connection for software installation

### Razer Chroma RGB app requirements

- iOS 12 / Android 8.1 Oreo (or higher) device with Bluetooth 5.1 connectivity
- Internet connection for app installation

---

## 2. LET'S GET YOU COVERED

You've got a great device in your hands, complete with a 1-year limited warranty coverage. Now maximize its potential and score exclusive Razer benefits by registering at [razerid.razer.com](https://razerid.razer.com)

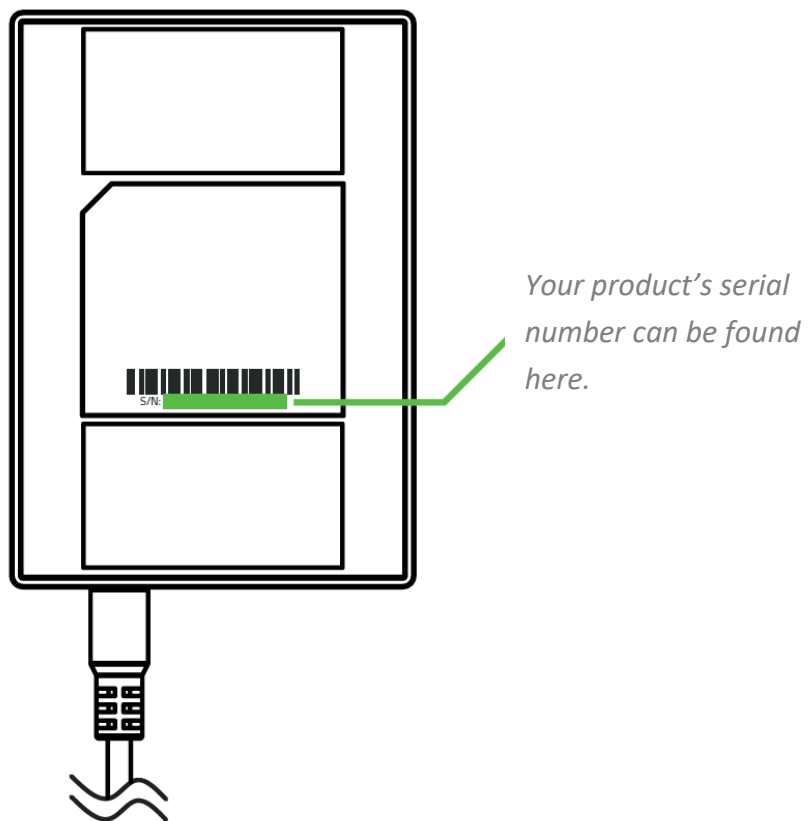

Got a question? Ask the Razer Support Team at [support.razer.com](https://support.razer.com)

---

## 3. TECHNICAL SPECIFICATIONS

### RAZER CHROMA WIRELESS ARGB CONTROLLER

- Connect wirelessly via Razer HyperSpeed Dongle or Bluetooth
- 3 Addressable RGB headers (3-pin, 5V)
- Support for WS2812b or equivalent LEDs (up to 120 LEDs per port, 240 LEDs total)
- Powered by Razer Chroma™ RGB for truly customizable lighting
- Supported by Razer Synapse 3 for streamlined control
- Supported by Razer Chroma™ RGB app for Android and iOS (Bluetooth control only)
- 3 on-device buttons for lighting effect/brightness control
- Double-sided adhesive for secure mounting to most common surfaces
- Razer HyperSpeed 2.4GHz Dongle: USB-A
- Power Adapter: AC to DC Wall adapter (12V 5A)

### 3 LED LIGHT STRIPS

- 1 x 100cm light strip : 60 LEDs each
- 2 x 50cm light strip : 30 LEDs each
- 5V 3-pin Addressable RGB LED
- Supports daisy-chaining
- Easy mounting using included brackets and double-sided adhesive



---

## 4. GETTING STARTED

### SETTING UP THE ARGB CONTROLLER

1. Insert the controller to LED strip connector cables to the 3-pin 5V ports of the ARGB controller and plug the LED strips to each cable.

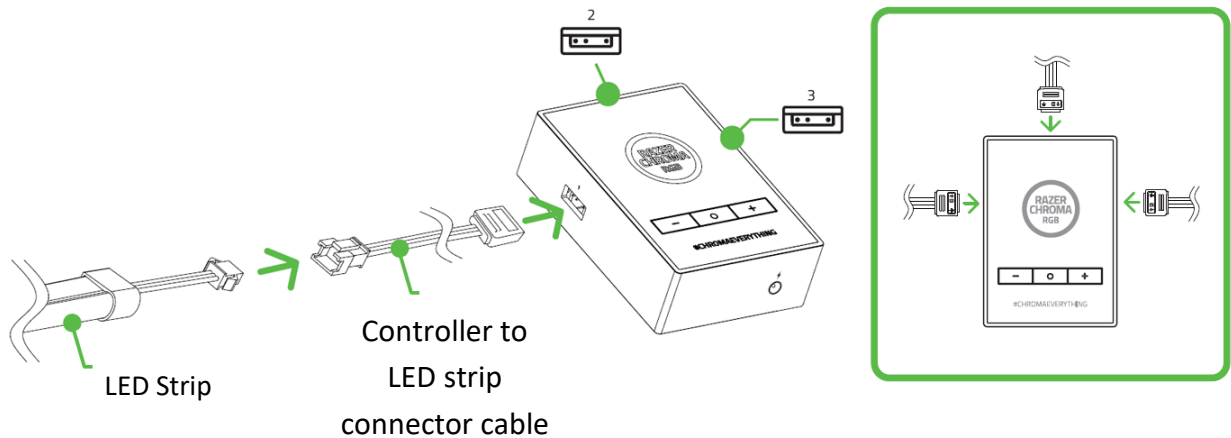

*Before plugging a controller to LED strip connector to any of the 3-pin 5V ports of the ARGB controller, make sure that its pins are properly aligned to the chosen port.*

Enclose all LED strip connections using the included protector clips to keep them from being unplugged or exposed to undue pressure.

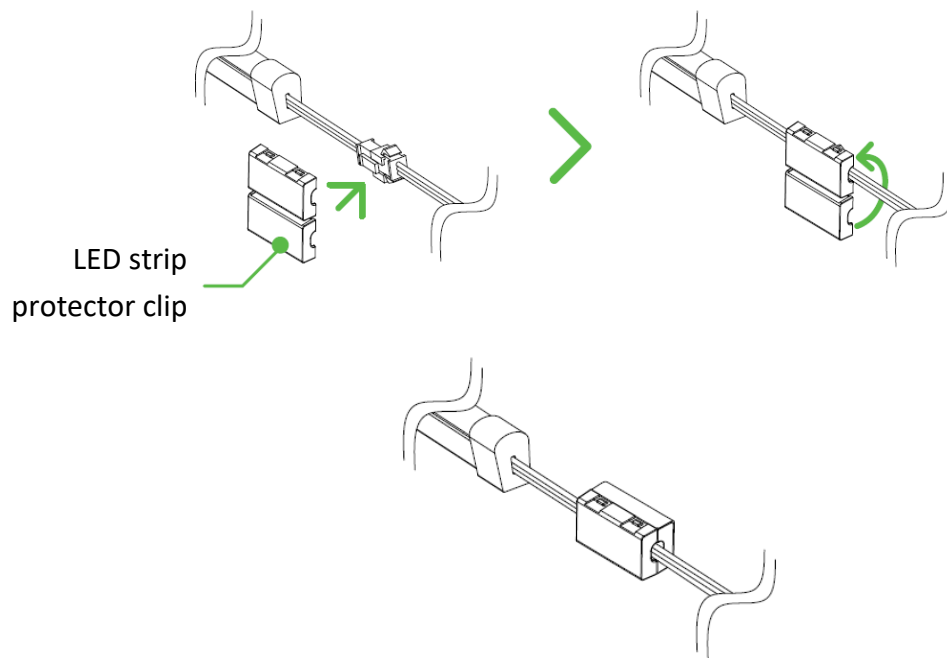

2. Select the appropriate AC plug for your region and attach it to the power adapter.



3. Connect the power adapter to the ARGB controller and plug it into a power outlet.

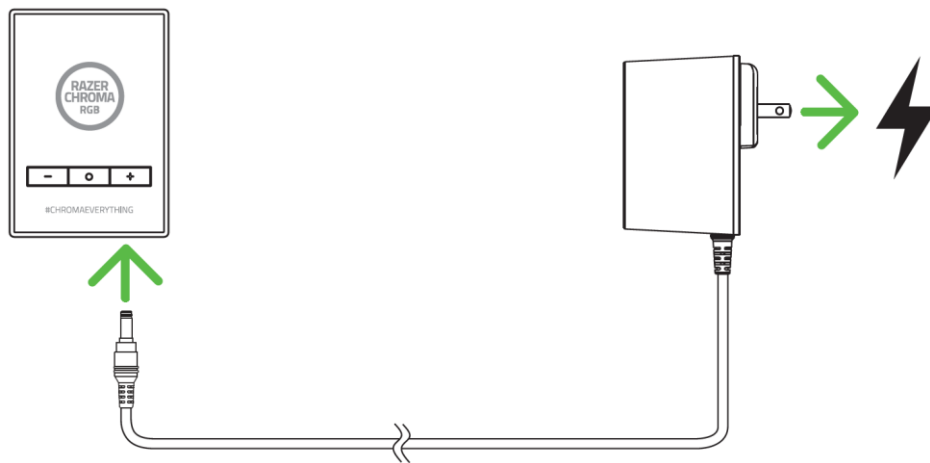

**i** This connection also acts as the Standalone mode for your ARGB controller.

4. You can make use of the double-sided adhesive tapes to fasten the ARGB controller on any clean, dry, and flat surface as needed.

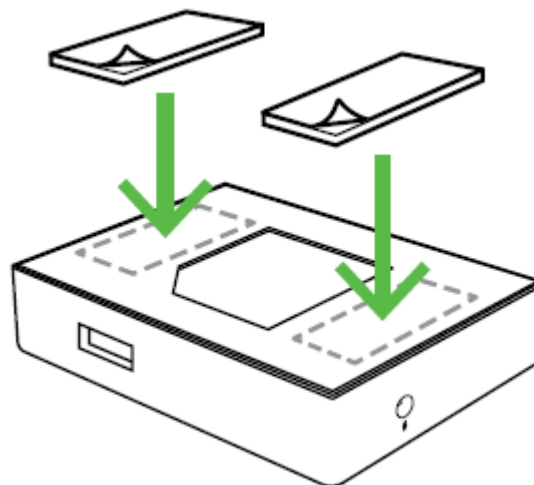

To mount any LED strip in your setup, insert the LED strip into mounting bracket(s) and attach it to surfaces using bracket adhesive tape(s) as required in your setup.

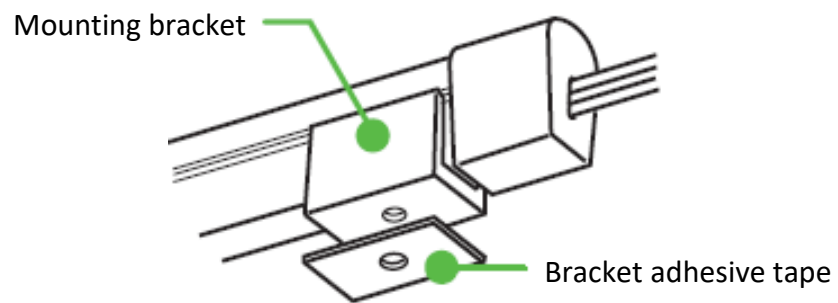

## PERSONALIZE YOUR LIGHTING SETUP

### Using the Razer Synapse app

Use the Razer Synapse app to access in-depth lighting customization options and integrate games and applications across your LED strips and Razer Chroma-enabled devices for a truly immersive and personalized lighting ecosystem. Find out more at [razer.com/chroma](https://www.razer.com/chroma)

#### A. Via 2.4 GHz mode

1. Insert the wireless USB transceiver into any of the USB ports on your PC.

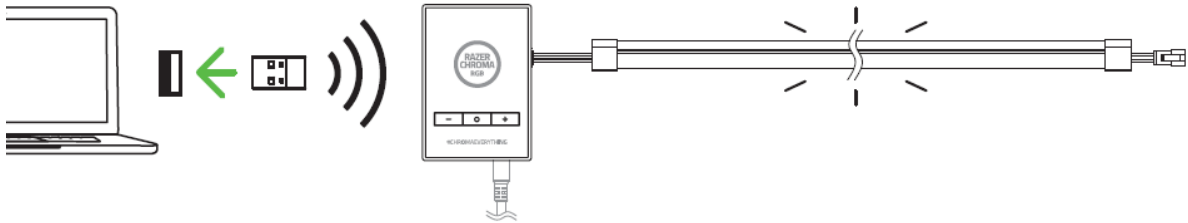

2. Press and hold the power button to turn on the ARGB controller.

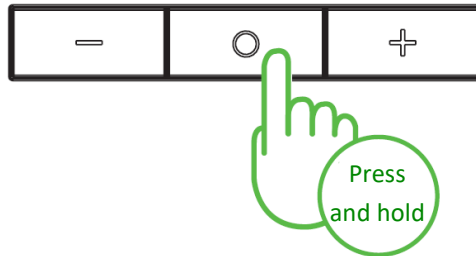

3. Install Razer Synapse when prompted or download the installer from [razer.com/synapse](https://www.razer.com/synapse).

#### B. Via Bluetooth mode

**i** When using Razer Synapse in Bluetooth mode, limited functionality and effects are available.

1. Press and hold the power button to turn on the ARGB controller.

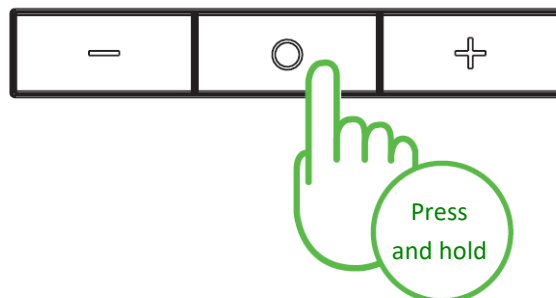

2. Press and hold the power and brightness control buttons simultaneously for 3 seconds to activate pairing mode. The first LED of each connected strip will blink in blue to show that the device is in pairing mode.

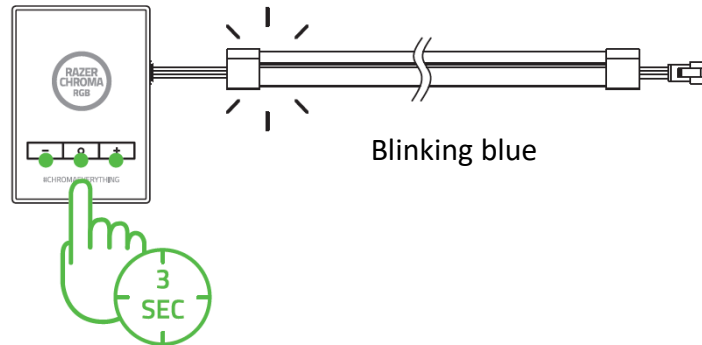

3. Activate Bluetooth on your device and select “**Razer ARGB**” from the list of devices found.
4. Wait until the ARGB controller pairs with your device. The LED strips will display a default spectrum of colors.

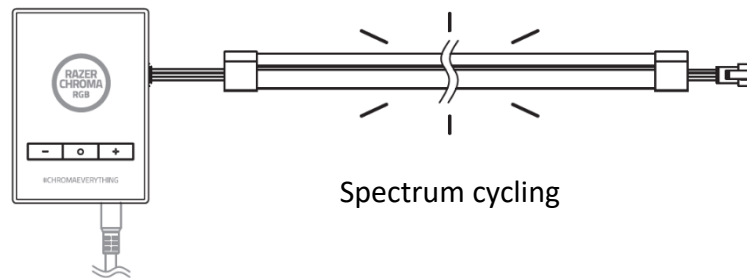

**i** *Once paired, your ARGB controller will automatically reconnect to your device whenever in Bluetooth mode and within range. Keep the pairing devices within close proximity of each other for a faster and more stable connection.*

## Using the Razer Chroma RGB app

With 16.8 million colors and a suite of effects to choose from, the Razer Chroma RGB app lets you instantly connect to your Chroma-enabled devices and fully customize your lighting setup with endless possibilities.

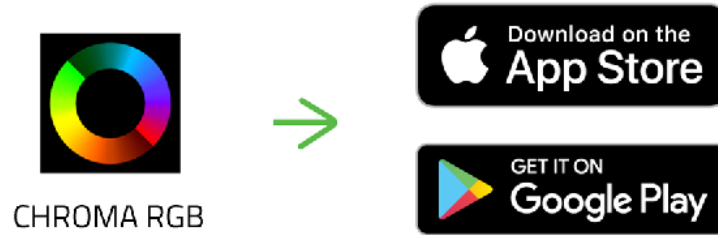

1. Download the Razer Chroma RGB app on your mobile device.
2. Launch the app, tap **Add Device**, and follow the onscreen instructions.

---

## 5. USING THE ARGB CONTROLLER

### BRIGHTNESS CONTROL BUTTONS

Press the + or - brightness control buttons to increase or decrease the brightness of all connected LED strips.

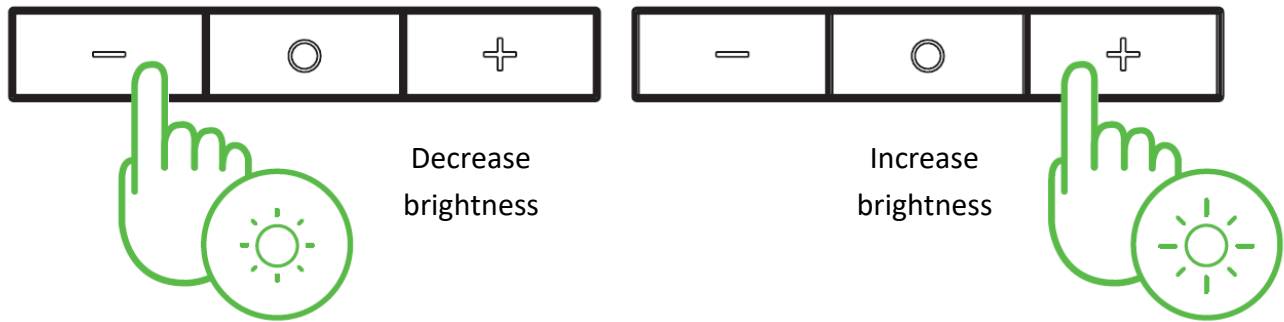

### POWER BUTTON

#### Power on/off lighting

Press and hold the power button to power on or off the ARGB controller.

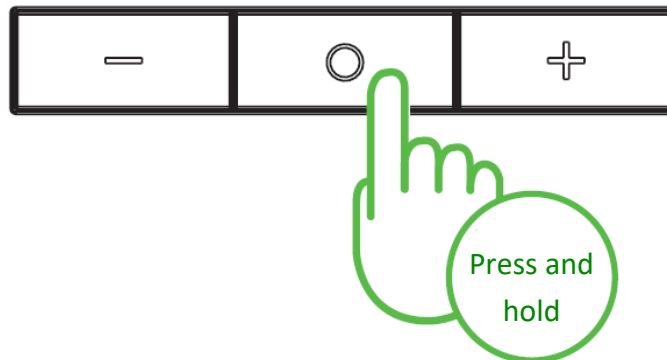



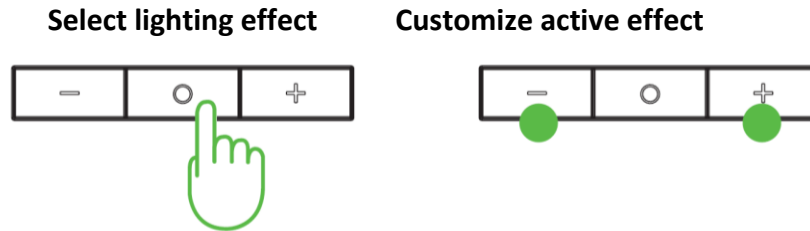

## Changing the lighting

**i** For Standalone and Bluetooth mode only.

When used in a standalone setup or connected via Bluetooth mode, pressing the power button will allow you to cycle through the Chroma lighting effects listed below. You may then configure the settings of the active lighting effect using the – and + brightness control buttons.



	Name	Description	How to customize
	Spectrum cycling	The lighting will cycle through a spectrum of colors	Press the + button to change how fast the colors will cycle
	Breathing	The lighting will fade in and out of the selected color	Cycle through colors by pressing the – button and use the + button to change the speed of the effect.
	Starlight	Each LED will have a chance of fading in and out using the active or a random color	Cycle through colors or randomize the active color by pressing the – button; and use the + button to change the frequency and speed of the effect.
	Wave	The lighting will scroll across the LEDs using a color pattern	Press the - button to cycle through available color patterns and the + button to change its speed.
	Static	The LEDs will remain lit in the selected color	Press the - button to cycle through available colors

**i** Upon pressing the power button to change to Breathing, Starlight, or Static lighting effect, a 5-second interval is required if you want to use the - button to change its color. All lighting effects can be customized further through Razer Synapse (PC) and the Razer Chroma RGB (mobile) app. Razer Synapse, however, will allow you to access and/or customize all available lighting effects on your ARGB controller when connected to your PC via 2.4 GHz mode.



---

## 6. CONFIGURING YOUR RAZER CHROMA WIRELESS ARGB CONTROLLER

**i** *Internet connection is required for installation, updates and cloud-based features. Registering for a Razer ID account is recommended, but optional. All listed features are subject to change based on the current software version, connected device(s), and supported apps and software.*

### SYNAPSE TAB

The Synapse tab is your default tab when you first launch Razer Synapse. This tab allows you to navigate the Dashboard subtab.

### Dashboard

The Dashboard subtab is an overview of your Razer Synapse where you can access all your Razer devices, modules, and online services.

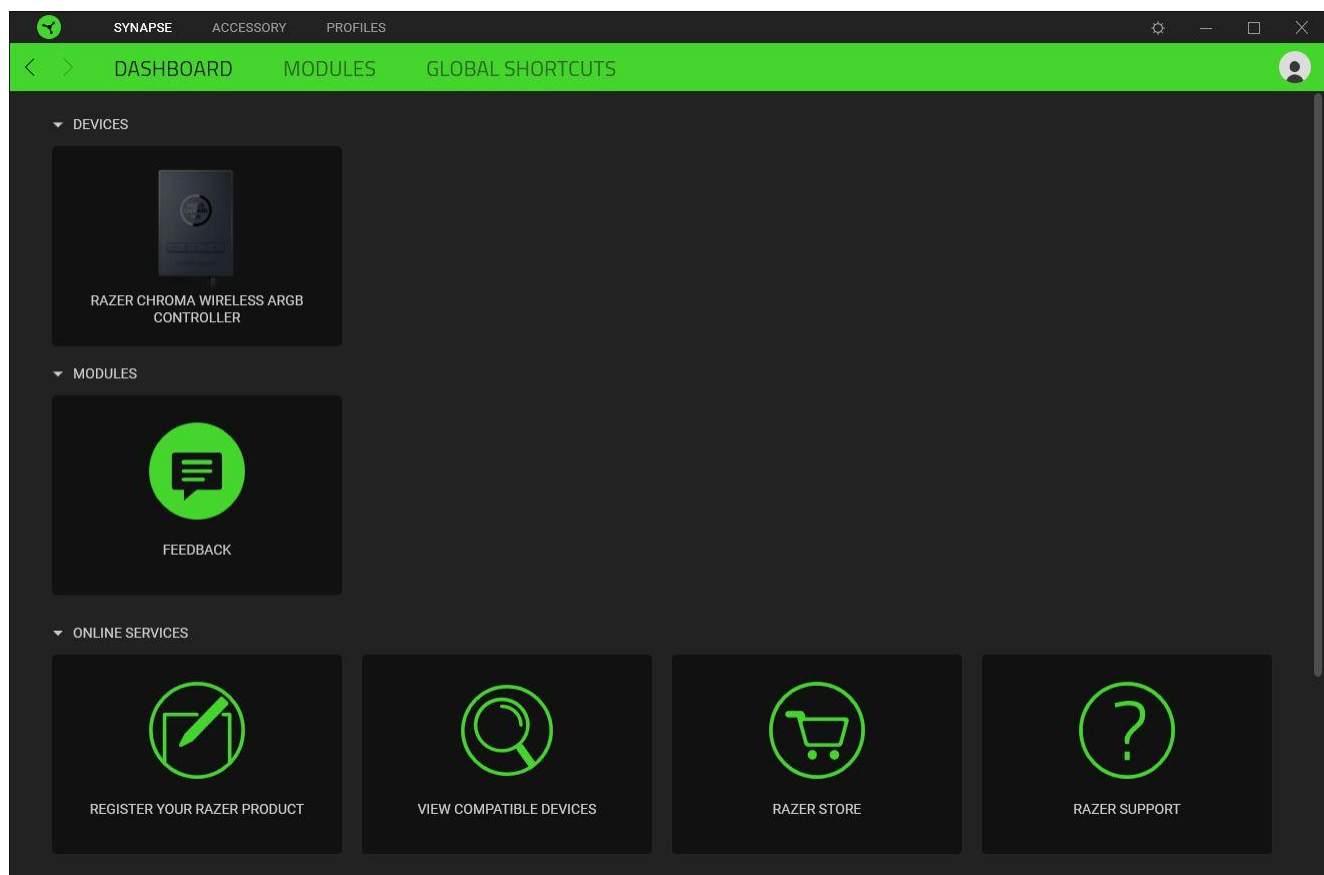

## Modules

The Modules subtab displays all installed and available modules for installation.

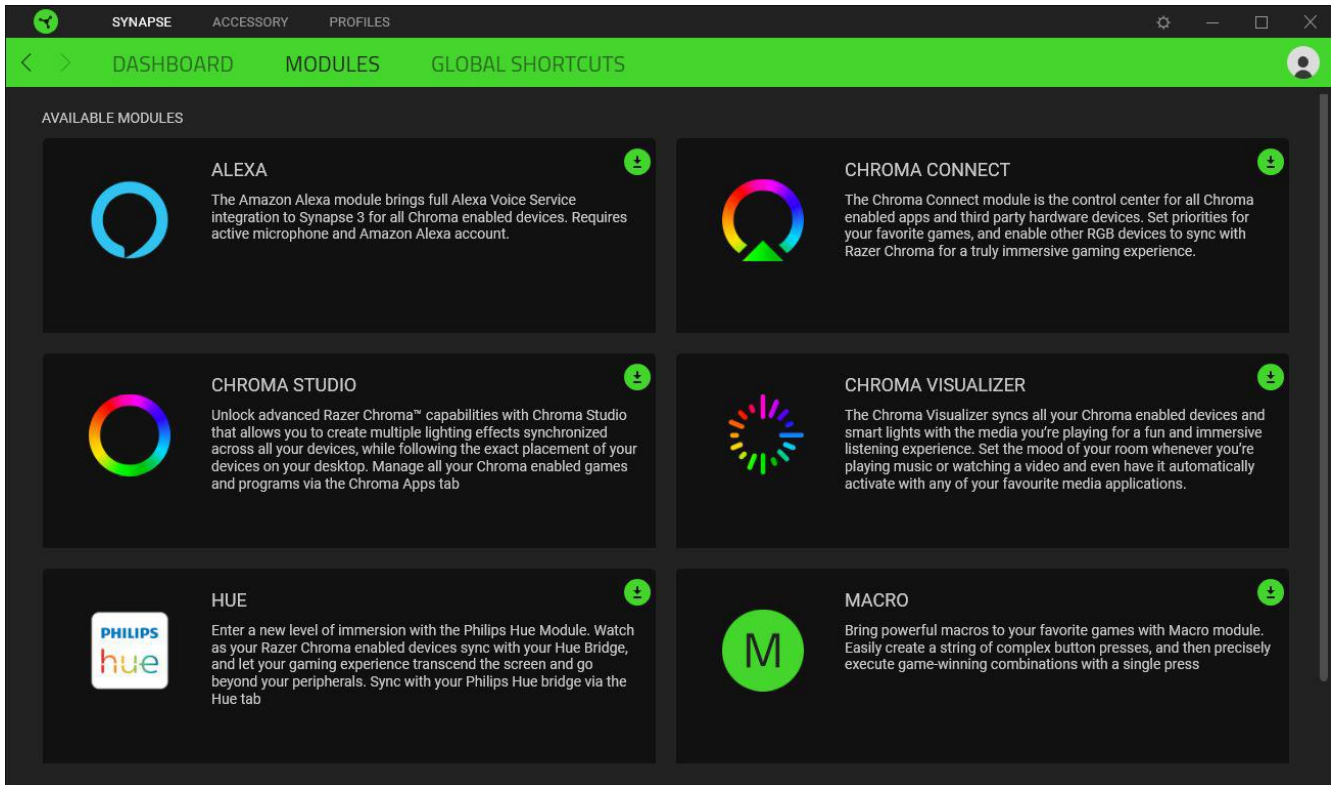

## Global Shortcuts

Bind operations or Razer Synapse functions to custom key-combinations from any Razer Synapse-enabled device inputs which apply across all device profiles. [Learn more about Profiles](#)

**!** *Only Razer Synapse-enabled device inputs will be recognized.*

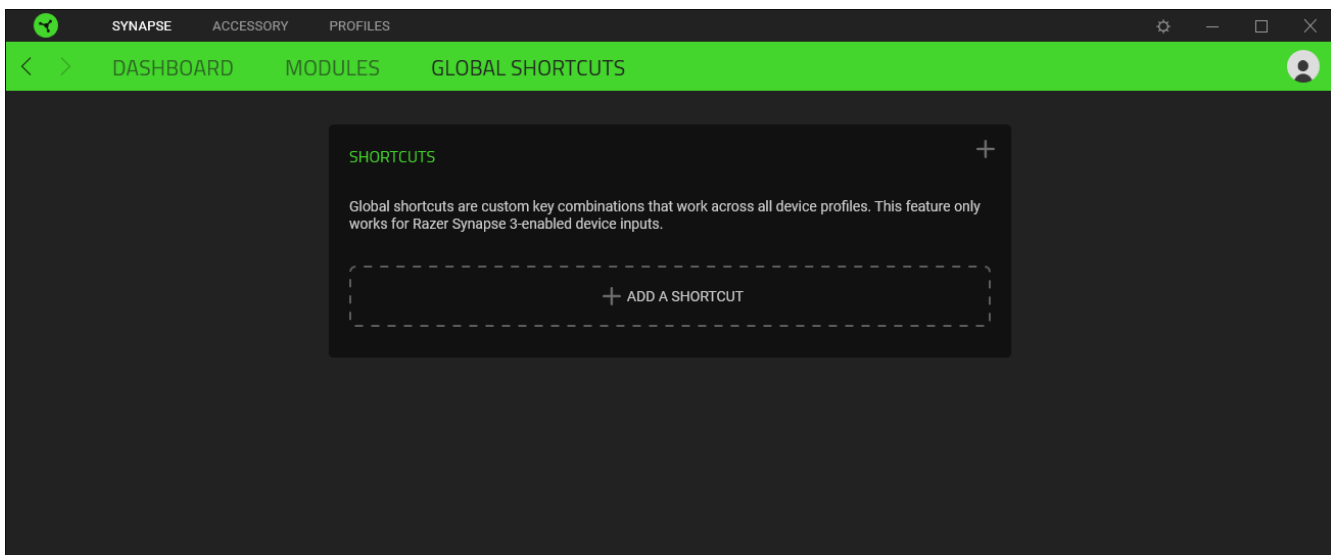

## ACCESSORY TAB

The Accessory tab is the main tab for your Razer Chroma Wireless ARGB Controller. From here, you'd be able to configure the properties of connected ARGB devices, customize ARGB LED strip bends (if applicable) and the lighting effect of any or all connected ARGB devices. Changes made under this tab are automatically saved to your system and cloud storage.

### Customize

The Customize subtab displays all ports with connected ARGB devices. You can also use this subtab to determine the type of ARGB device connected to each port and the number of LEDs on each connected ARGB device.

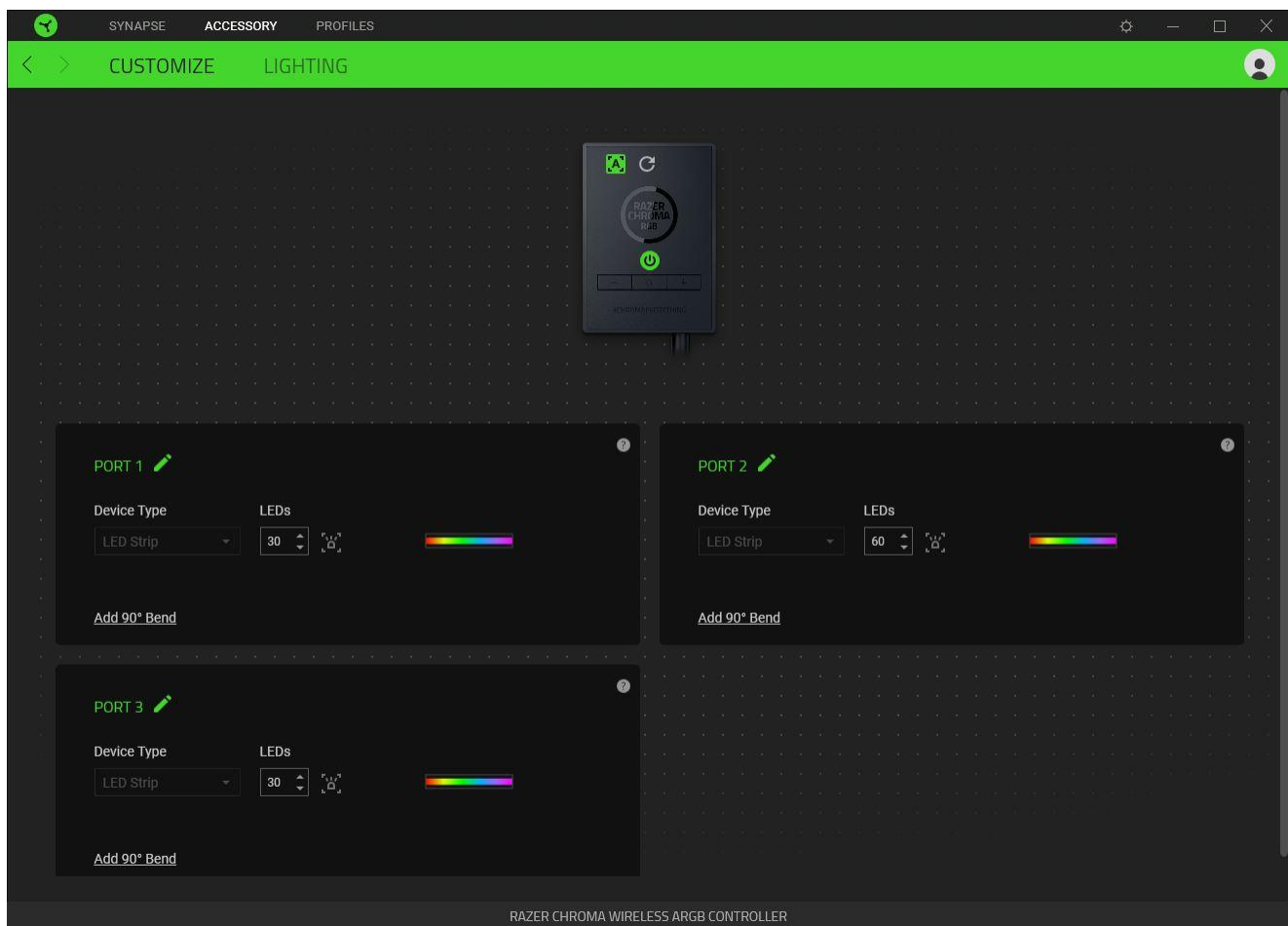

### Auto-Detect / Manual Detection

By default, the ARGB controller is set to Auto-detect (  ). This allows Razer Synapse to automatically detect all ports with connected ARGB devices on startup.

Upon connecting and/or removing ARGB devices from any port, clicking on the Refresh button (  ) will allow you to manually trigger detection on all ports. Active ports will then be re-displayed while all inactive ports will immediately be removed.

## Power on / off

You can turn on or off the ARGB controller via Razer Synapse by clicking on the power button (🔌).

## Port

Active ports will automatically be displayed together with the estimated LED count of its corresponding ARGB device.

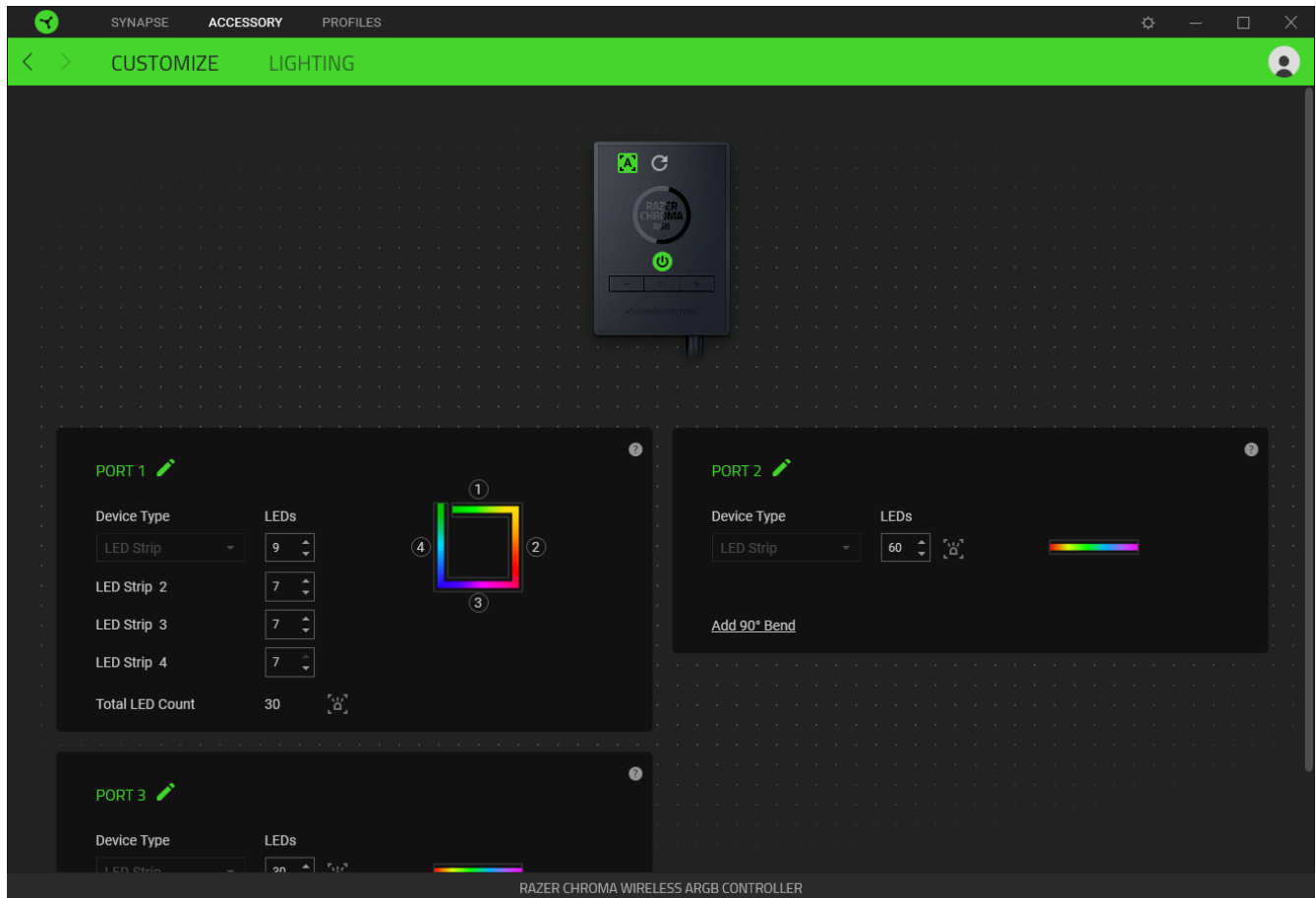

On each active Port, the following settings are available:

- **Device Type.** Displays the type of device connected to a corresponding port.
- **No. of LEDs.** Sets the number of LEDs a connected device will have. By default, Razer Synapse detects the number of LEDs each connected strip or device has.
- **Add 90° bend (for LED Strips only).** Allows you to strategically mimic how an LED strip is bent on your physical setup. Each LED strip can be bent up to four (4) times. Clicking on any bend's corresponding delete button (✕) will allow you to remove it from an LED strip.

**NOTE: These bends are essential if you want to customize specific sections on any LED strip separately. However, LED-specific customizations can only be made using the Chroma Studio module.**



For more detailed information, please install the Chroma Studio module and view its Master Guide under Settings > General.

## Lighting

The Lighting subtab enables you to customize the lighting of any or all connected ARGB devices.

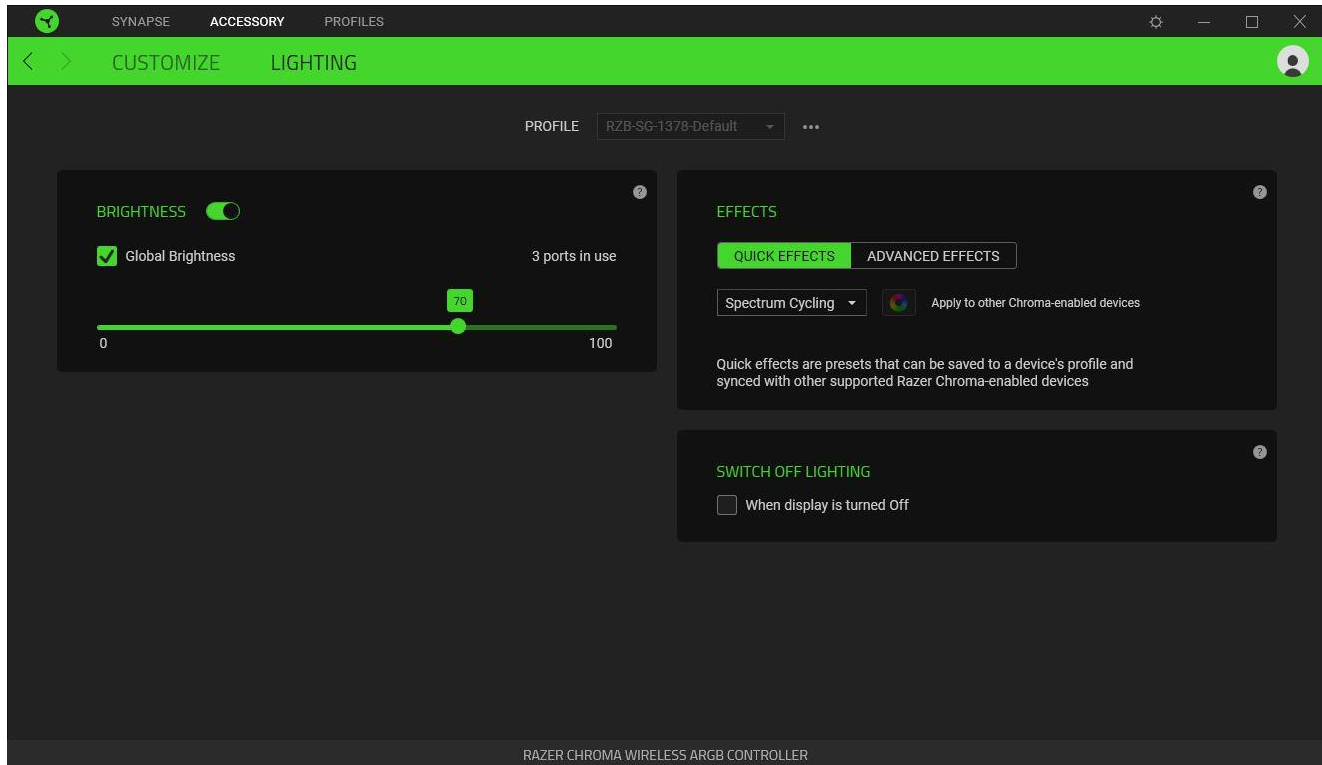

### Profile







A Profile is a data storage for keeping all your Razer devices' settings. By default, the profile name is based on your system's name. To add, import, rename, duplicate, export, or delete a profile, simply press the profile's corresponding Miscellaneous button ( ●●● ).

### Brightness

You can turn off the lighting of each connected ARGB device by toggling the Brightness option or increase/decrease the luminance on any port by adjusting its corresponding slider. Alternatively, you can enable Global Brightness if you want to adjust a single brightness setting for all ports.

## Quick Effects

A number of quick effects can be selected and applied to all connected ARGB devices as listed here:

	Name	Description	How to set up
	Ambient awareness	The LEDs will reflect the averaged color on the selected screen region	Select or customize a screen region
	Audio meter	The LEDs will light up according to the audio level with a default spectrum of colors	Select a Color Boost level
	Breathing	The lighting will fade in and out of the selected color(s)	Select up to 2 colors or randomize colors
	Spectrum cycling	The lighting will cycle through a spectrum of colors	No further customization required
	Starlight	Each LED will have a chance of fading in and out at a random time and duration	Select up to 2 colors or randomize colors and select a duration
	Static	The LEDs will remain lit in the selected color	Select a color
	Wave	The lighting will scroll across the LEDs in the direction selected	Select a wave direction

If you have other supported Razer Chroma-enabled devices, you can synchronize their quick effects with your Razer device by clicking the Chroma Sync button (  ).

 Only devices that support the selected lighting effect will synchronize.

## Advanced Effects

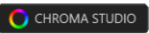
The Advanced Effects option allows you to choose a Chroma Effect you want to use on your Razer Chroma-enabled device. To start making your own Chroma Effect, simply press the Chroma Studio button (  ).

### *Switch Off Lighting*

This is a power saving tool which allows you to disable all lighting in response to your system's display turning off.

## PROFILES TAB

The Profiles tab is a convenient way of managing all your profiles and linking them to your games and applications.

### Devices

View which games are linked to each device's profiles or which Chroma Effect is linked to specific games using the Devices subtab.

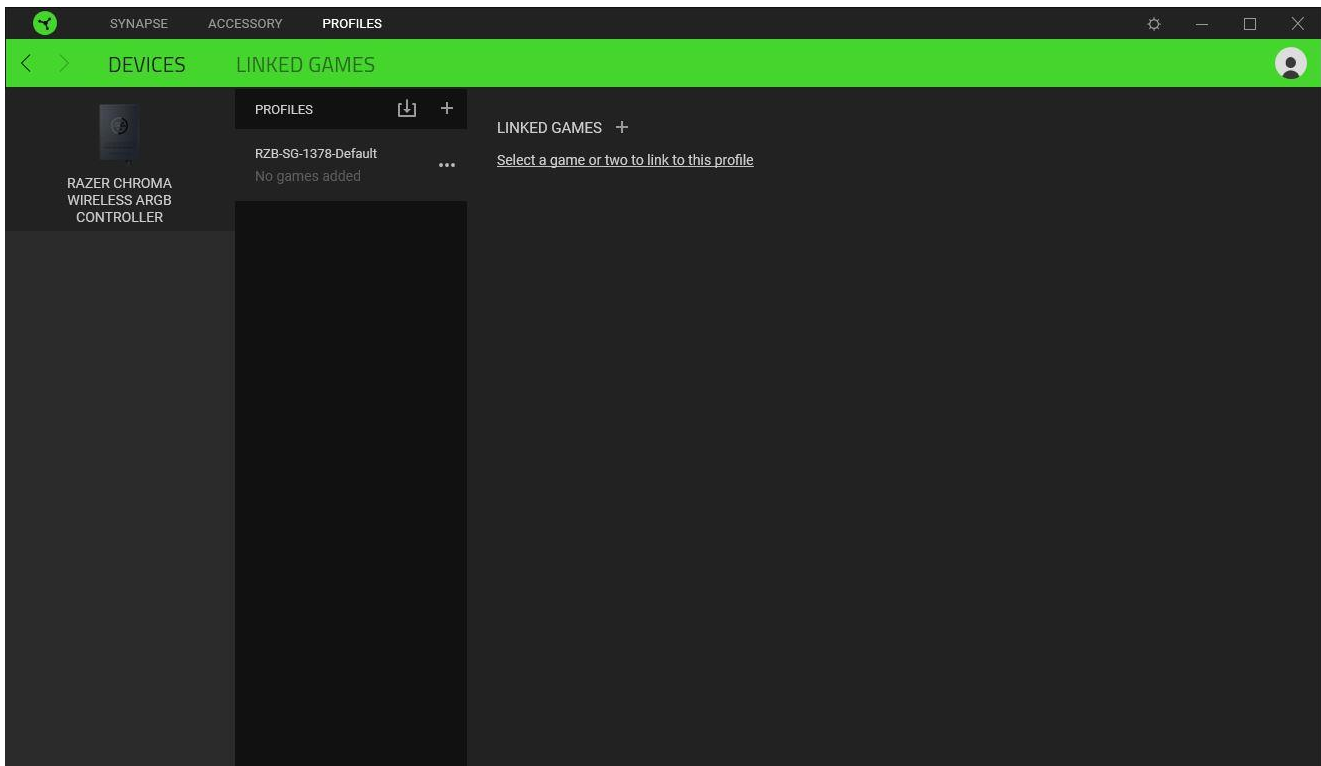

You can import Profiles from your computer or from the cloud through the import button ( ⏏ ) or create new profiles within the selected device using the add button ( + ). To rename, duplicate, export, or delete a profile, simply press the Miscellaneous button ( ●●● ). Each profile can be set to automatically activate when you run an application using the Linked Games option.



## Linked Games

The Linked Games subtab gives you the flexibility to add games, view devices that are linked to games, or search for added games. You can also sort games based on alphabetical order, last played, or most played. Added games will still be listed here even if it is not linked to a Razer device.

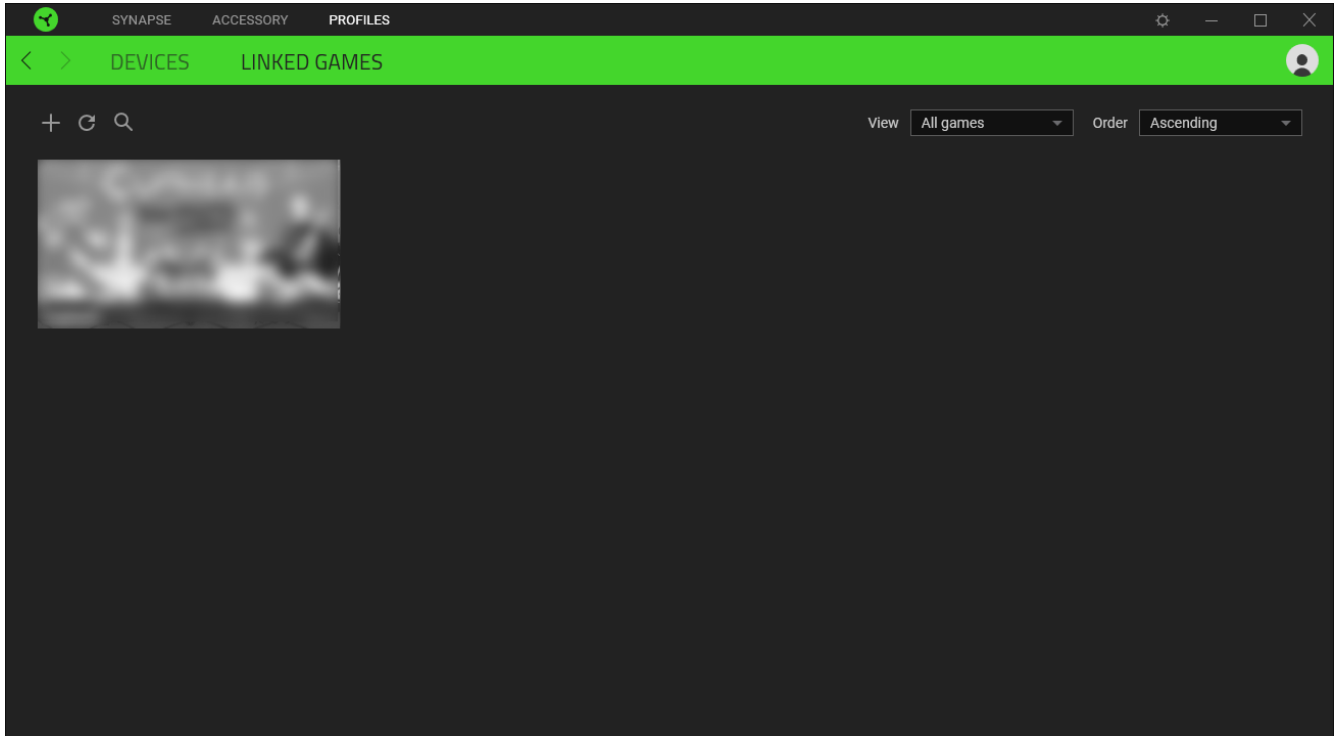

To link games to connected Razer devices or Chroma Effects, simply click on any game from the list, and then click **Select a device and its profile to launch automatically during gameplay** to select the Razer device or Chroma Effect it will link with. Once linked, you may click on the Miscellaneous button ( ●●● ) of the corresponding Chroma Effect or device to select a specific Chroma Effect or profile.

## SETTINGS WINDOW

The Settings window, accessible by clicking the ( ⚙ ) button on Razer Synapse, enables you to configure the startup behavior and display language of Razer Synapse, view the master guides of each connected Razer device, or perform factory reset on any connected Razer device.

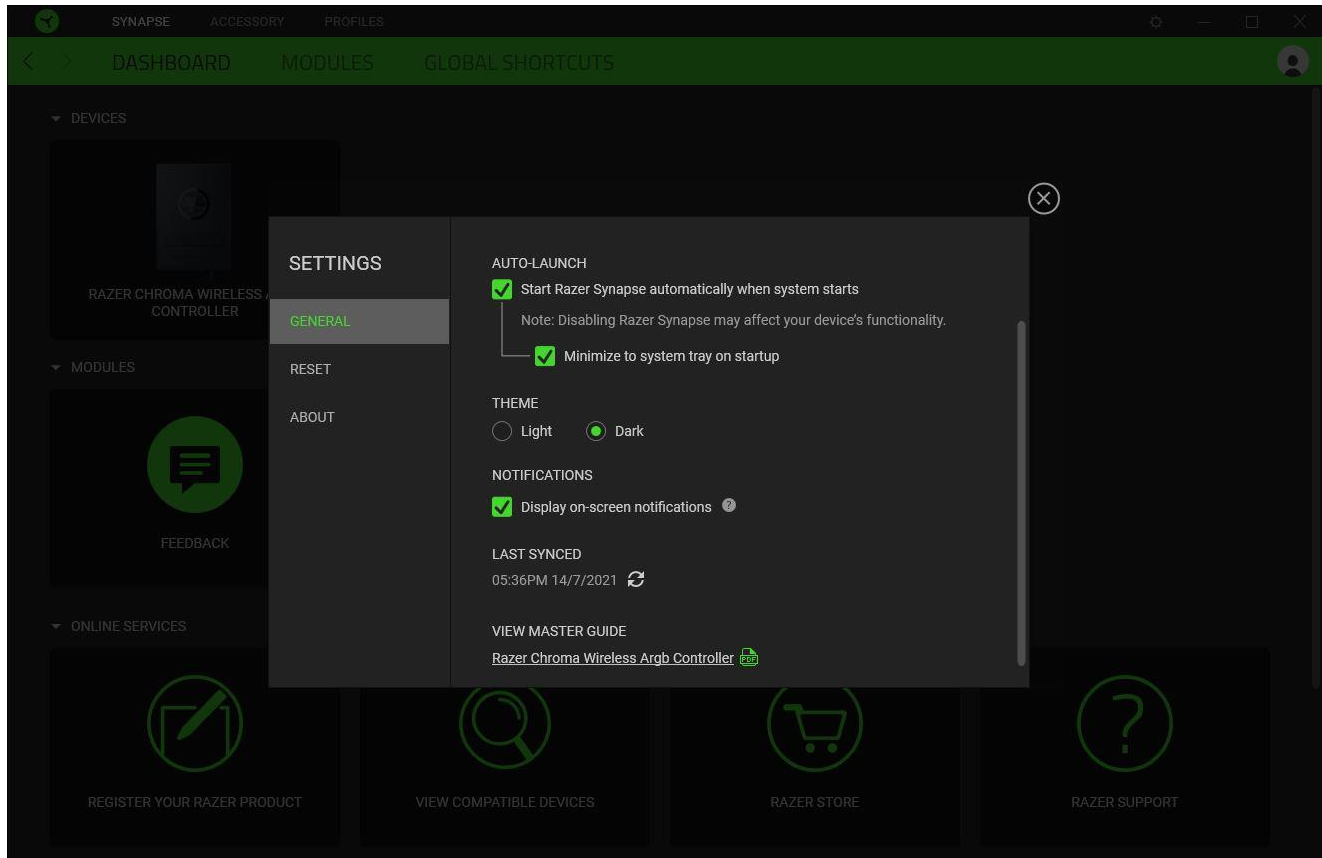

### General tab

The default tab of the Settings window. The General tab enables you to change the software's display language, start-up behavior, display theme, and on-screen notifications display. You may also manually sync your profiles to the cloud ( ↻ ) or view the master guide of all connected Razer devices and installed modules.

### Reset tab

The Reset tab allows you to perform a factory reset on all connected Razer devices with on-board memory and/or reset Razer Synapse tutorials to acquaint yourself again with Razer Synapse's new features on its next launch.



*By resetting a Razer device, all profiles stored on the selected device's on-board memory will be erased.*

**About tab**

The About tab displays brief software information, copyright statement and provides relevant links for its terms of use. You may also use this tab to check for software updates, or as a quick access to Razer's social communities.

---

## 7. SAFETY AND MAINTENANCE

### SAFETY GUIDELINES

In order to achieve maximum safety while using your Razer Chroma Light Strip Set, we suggest that you adopt the following guidelines:

- Should you have trouble operating the device properly and troubleshooting does not work, unplug the device and contact the Razer hotline or go to [support.razer.com](https://support.razer.com) for support. Don't attempt to service or fix the device yourself at any time.
- Don't take apart the device and don't attempt to operate it under abnormal current loads. Doing so may void your warranty.
- Only use accessories provided with the device and only purchase accessories made and/or approved by Razer.
- Power off the device before making any relocation, modifications, and/or connecting/disconnecting any component.
- Always handle all included accessories with care. When plugging or unplugging any accessory, always grip its plug/connector.
- When connecting LED strips to the device please power off and unplug the device to avoid electric shocks.
- Don't use or install the device and its components near water, moisture, solvents, or other wet surfaces, nor expose these components to high temperatures or direct sunlight.
- Keep the device and its components away from liquid, humidity or moisture. Operate the device and its components only within the specific temperature range of 0°C (32°F) to 40°C (104°F). Should the temperature exceed this range, unplug and switch off the device in order to let the temperature stabilize to an optimal level.

### MAINTENANCE AND USE

The Razer Chroma Light Strip Set requires minimum maintenance to keep it in optimum condition. Once a month we recommend you unplug the device from the computer, unplug all connected components, and clean it using a soft cloth or cotton swab to prevent dirt buildup. Do not use soap or harsh cleaning agents.

---

## 8. LEGALESE

### COPYRIGHT AND INTELLECTUAL PROPERTY INFORMATION

©2021 Razer Inc. All rights reserved. Razer, the triple-headed snake logo, Razer logo, “For Gamers. By Gamers.”, and “Razer Chroma” logo are trademarks or registered trademarks of Razer Inc. or affiliated companies in the United States and other countries. All other trademarks are the property of their respective owners.

©2018 Google LLC All rights reserved. Android, Google, Google Logo, Google Play, and the Google Play logo are registered trademarks of Google LLC.

Apple, the Apple logo, and iPhone are trademarks of Apple Inc., registered in the U.S. and other countries. App Store is a service mark of Apple Inc.

The Bluetooth® word mark and logos are registered trademarks owned by Bluetooth SIG, Inc., and any use of such marks by Razer is under license.

Windows and the Windows logo are trademarks of the Microsoft group of companies.

Razer Inc. (“Razer”) may have copyright, trademarks, trade secrets, patents, patent applications, or other intellectual property rights (whether registered or unregistered) concerning the product in this guide. Furnishing of this guide does not give you a license to any such copyright, trademark, patent or other intellectual property right. The Razer Chroma Light Strip Set (the “Product”) may differ from pictures whether on packaging or otherwise. Razer assumes no responsibility for such differences or for any errors that may appear. Information contained herein is subject to change without notice.

### LIMITED PRODUCT WARRANTY

For the latest and current terms of the Limited Product Warranty, please visit [razer.com/warranty](https://www.razer.com/warranty).

### LIMITATION OF LIABILITY

Razer shall in no event be liable for any lost profits, loss of information or data, special, incidental, indirect, punitive or consequential or incidental damages, arising in any way out of distribution of, sale of, resale of, use of, or inability to use the Product. In no event shall Razer’s liability exceed the retail purchase price of the Product.

### GENERAL

These terms shall be governed by and construed under the laws of the jurisdiction in which the Product was purchased. If any term herein is held to be invalid or unenforceable, then such term (in

so far as it is invalid or unenforceable) shall be given no effect and deemed to be excluded without invalidating any of the remaining terms. Razer reserves the right to amend any term at any time without notice.