

NZXT

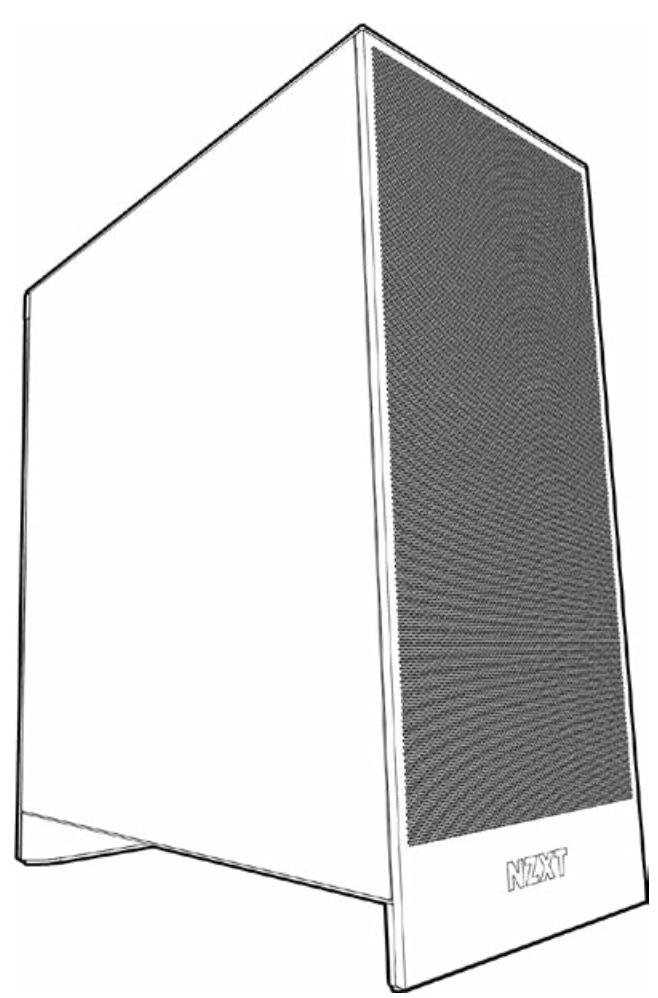

H7 FLOW & H7 FLOW RGB

MID-TOWER ATX AIRFLOW CASE

EXPLODED VIEW

VISTA EXPLOSIONADA
VUE EXPLODIÉE
EXPLOSIONSBARSTELLUNG
VEDUTA IN ESPLOSO
VISTA EXPLODIDA
爆炸圖
圖解圖
部件分解圖
部件分解圖

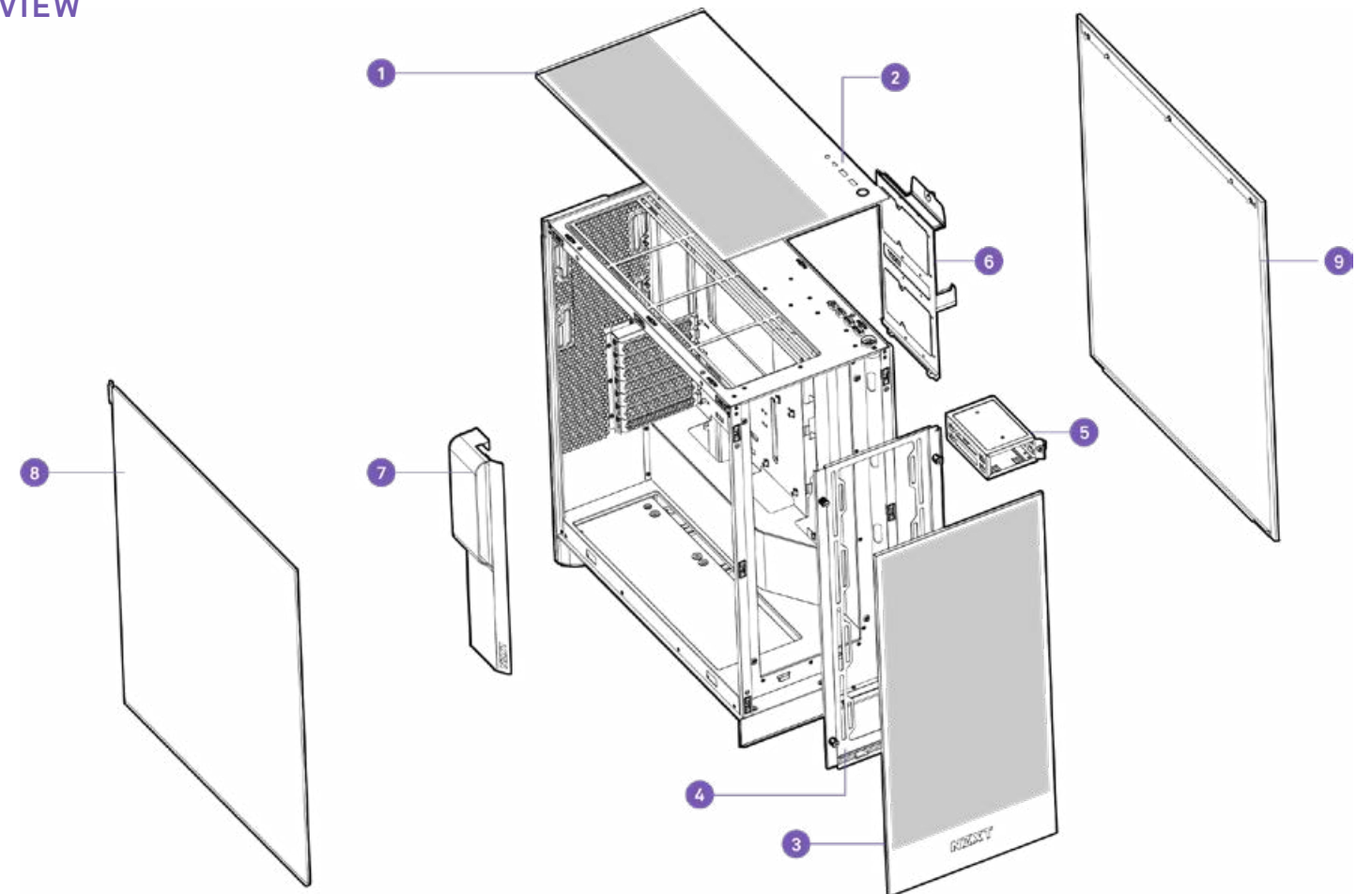

1. Top Panel
2. Top I/O module
3. Front panel
4. Removable front radiator/fan bracket
5. SSD Cage
6. HDD Tray
7. Cable bar
8. Tempered glass panel
9. Right side panel

1. Panneau supérieur
2. Module E/S supérieur
3. Panneau avant
4. Support de radiateur/radiateur frontal amovible
5. Logement pour disque SSD
6. Plateau du disque dur
7. Barre de balayage pour nettoyage
8. Panneau gauche en verre trempé
9. Panneau latéral droit

1. Painel superior
2. Módulo de entrada/saída superior
3. Painel frontal
4. Soporte de ventoinha/radiador frontal removível
5. Compartimento para SSD
6. HDD-Schale
7. Reinigungselekte
8. Painel esquerdo em vidro temperado
9. Painel lateral direito

1. 頂部面板
2. 頂部 I/O 模塊
3. 前面板
4. 可拆卸的前置散熱器/風扇支架
5. 固態硬碟架
6. 硬碟托架
7. 清潔刷
8. 左側強化玻璃面板
9. 右側面板

CLEARANCES AND SPECIFICATIONS

MEDIDAS Y ESPECIFICACIONES
MÉTRICAS
DIMENSIONES E ESPECIFICAÇÕES
DIMENSIONES E ESPECIFICAÇÕES

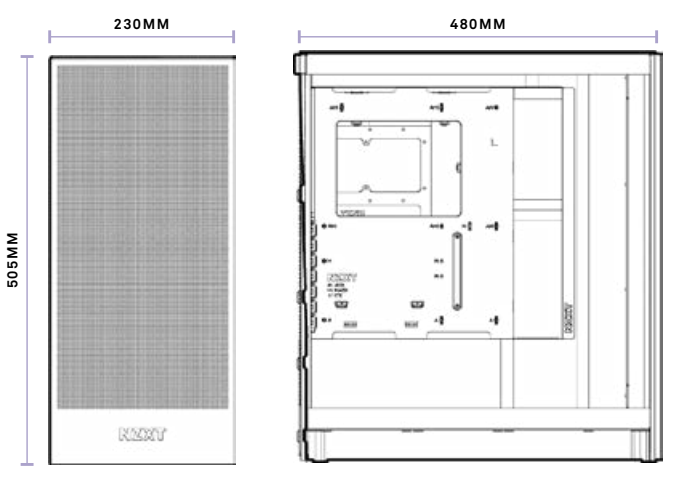

Motherboard Support	EATX, ATX, Micro-ATX and Mini-ITX
2.5" SSD Support	2+2
3.5" HDD Support	2
Expansion Slots	7
Cable Management Space	Up to 34.5mm
GPU Clearance	Up to 185mm
GPU Length	Up to 410mm
PSU Length	Up to 200mm
Top Mounted Radiator / Radiator & Fan Combined Thickness	Up to 140mm / 280mm

Placas base admitidas	EATX, ATX, Micro-ATX y Mini-ITX
Unidad de estado sólido de 2.5"	2+2
Unidad de disco duro de 3.5"	2
Ranuras de expansión	7
Espacio para gestión de cables	Hasta 34.5 mm
Espacio para refrigerador del procesador	Hasta 185 mm
Espacio para gráfica	Hasta 410 mm
Longitud de la fuente de alimentación	Hasta 200 mm
Grosor de radiador y ventilador de 140 mm/280 mm combinados en la parte superior	Hasta 57 mm

Cartes mère prises en charge	EATX, ATX, MicroATX, MiniITX	메이보드 지원	EATX, ATX, Micro ATX, Mini ITX
SSD 2.5"	2+2	2.5" SSD	2+2
Disques durs 3.5"	2	3.5" HDD	2
Fentes d'expansion	7	확장 슬롯	7
Espace pour la gestion des câbles	Jusqu'à 34,5 mm	케이블 관리 공간	최대 34.5mm
Espace libre au niveau du refroidisseur de processeur	Jusqu'à 185 mm	CPU 쿨러 길이	최대 185mm
Espace libre au niveau de la carte graphique	Jusqu'à 410 mm	GPU 길이	최대 410mm
Longueur de l'alimentation	Jusqu'à 200 mm	PSU 길이	최대 200mm
Épaisseur cumulée radiateur et ventilateur 140 mm / 280 mm à montage supérieur	Jusqu'à 57 mm	상단 장착형 140mm / 280mm 라디에이터 및 팬 결합 두께	최대 57mm

Motherboard-Unterstützung	EATX, ATX, Micro-ATX, Mini-ITX	마더보드 지원	EATX, ATX, Micro-ATX, Mini ITX
2,5-Zoll-SSD	2+2	2.5" SSD 지원	2+2
3,5-Zoll-Festplatte	2	3.5" HDD 지원	2
Erweiterungsteckplätze	7	확장 슬롯	7
Platz für Kabelmanagement	Bis zu 34,5 mm	케이블 관리 스페이스	최대 34.5 mm
Freiraum für CPU-Kühler	Bis zu 185 mm	CPU 쿨러의 클리어런스	최대 185 mm
Freiraum für GPU	Bis zu 410 mm	GPU 클리어런스	최대 410 mm
Länge des Netzteils	Bis zu 200 mm	PSU 길이	최대 200 mm
Kombinierte Dicke des oben montierten 140/280-mm-Radiators und Lüfters	Bis zu 57 mm	탑 장착형 140mm / 280mm 프로세서 쿨러와 팬의 결합 두께	최대 57 mm

Scheda madre supportata	EATX, ATX, Micro ATX, Mini ITX	주요 지원	EATX, ATX, Micro ATX, Mini ITX
SSD 2.5"	2+2	2.5" SSD 지원	2+2
HDD 3.5"	2	3.5" HDD 지원	2
Alloggi d'espansione	7	확장 슬롯	7
Spazio gestione cavi	Fino a 34,5mm	케이블 관리 공간	최대 34.5mm
Ingombro refrigeratore per CPU	Fino a 185mm	CPU 쿨러 높이	최대 185mm
Ingombro per GPU	Fino a 410mm	GPU 높이	최대 410mm
Lunghezza alimentatore	Fino a 200mm	PSU 길이	최대 200mm
Montaggio in alto 140mm / 280mm spessore radiatore & ventola combinati	Fino a 57mm	최대 140mm / 280mm 라디에이터 및 팬 높이	최대 57mm

Placa-principais suportadas	EATX, ATX, Micro-ATX, Mini-ITX	주요 지원	EATX, ATX, Micro ATX, Mini ITX
SSD de 2,5"	2+2	2.5" SSD 지원	2+2
HDD de 3,5"	2	3.5" HDD 지원	2
Ranuras de expansão	7	확장 슬롯	7
Espaco para gestão de cabos	Até 34,5 mm	케이블 관리 공간	최대 34.5 mm
Espaco necessário para o refrigerador de CPU	Até 185 mm	CPU 쿨러 높이	최대 185 mm
Espaco necessário para a GPU	Até 410 mm	GPU 높이	최대 410 mm
Comprimento da fonte de alimentação	Até 200 mm	PSU 길이	최대 200 mm
Espessura combinada de ventoinha e radiador de 140 mm/280 mm montados no topo	Até 57 mm	최대 140mm / 280mm 라디에이터 및 팬 높이	최대 57 mm

ACCESSORY BOX

CAJA DE ACCESORIOS
BOITE D'ACCESSOIRES
ZUBEHÖRSET
SCATOLA DEGLI ACCESSORI
CAIXA DE ACESSÓRIOS
악세서리 상자
部品箱 (説明書入り)
配件盒
零件盒

- A** Hexagon Screw 6-32 x 6mm x4
- B** Screw 6-32 x 5mm x17
- C** Screw M3 x 5mm x16
- D** Screw CB5 x 10mm x28
- E** Flathead CB5 x 13.5mm x12
- F** Standoff 6-32 x 6.5+4mm x1
- G** Standoff Wrench x1
- H** Cable ties x10

- A.** Hexagon Screw 6-32 x 6mm Power supply installation
- B.** Screw 6-32 x 5mm Motherboard installation, 3.5 hard drive installation
- C.** Screw M3 x 5mm 2.5 hard drive installation
- D.** Screw CB5 x 10mm Fan installation
- E.** Flathead CB5 x 13.5mm Fan installation
- F.** Standoff 6-32 x 6.5+4mm Motherboard installation
- G.** Standoff Wrench Motherboard installation
- H.** Cable Tie Cable management

- A.** Parafusos hexagonal 6-32 x 6mm Instalação da fonte de alimentação
- B.** Parafusos 6-32 x 5 mm Instalação da placa principal, instalação da unidade de 3.5"
- C.** Parafusos M3 x 5 mm Instalação da unidade de 2.5"
- D.** Parafusos CB5 x 10 mm Instalação da ventoinha
- E.** Parafusos CB5 x 13.5 mm Instalação da ventoinha
- F.** Separadores 6-32 x 6.5+4mm Instalação da placa principal
- G.** Chave para separador Instalação da placa principal
- H.** Braçadeira para cabos Gestão de cabos

CABLE CONNECTIONS

DISCO DE ADMINISTRACIÓN DE CABLES
CONNEXIONS DES CÂBLES
KABELVERBINDUNGEN
COLLEGAMENTI DEI CAVI
LIGAÇÕES DE CABOS

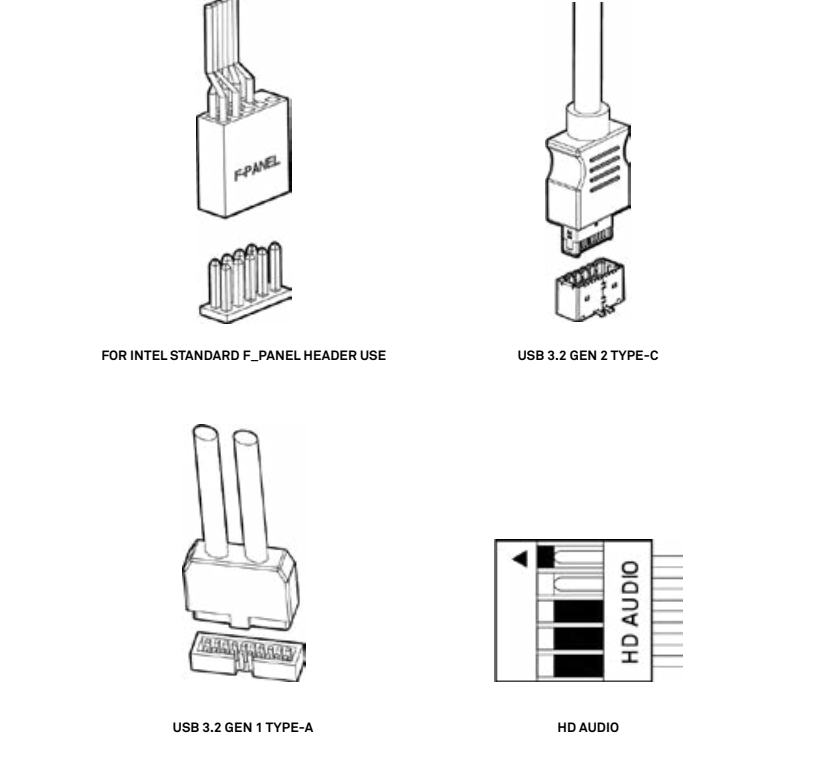

BUTTONS AND I/O

BOTONES Y E/S
CONNEXIONS DES CÂBLES
TASTEN UND I/O
PULSANTI E I/O
BOTÕES E E/S
네트워크 및 I/O
버튼과 I/O
按钮和 I/O

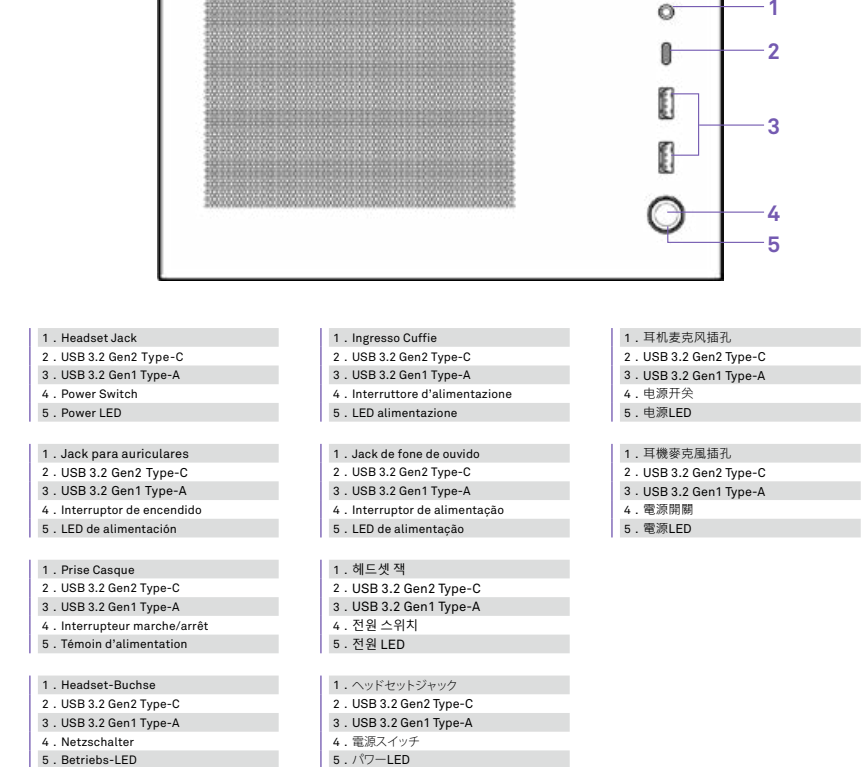

CABLE MANAGEMENT

SISTEMA DE GESTIÓN DE CABLES
SYSTEME DE CÂBLAGE
KABELMANAGEMENTSYSTEM
SISTEMA DI GESTIONE DEI CAVI
SISTEMA DE GERENCIAMENTO DE CABOS
케이블 관리 시스템
ケーブルマネジメントシステム
整理管理系統
配線管理系統

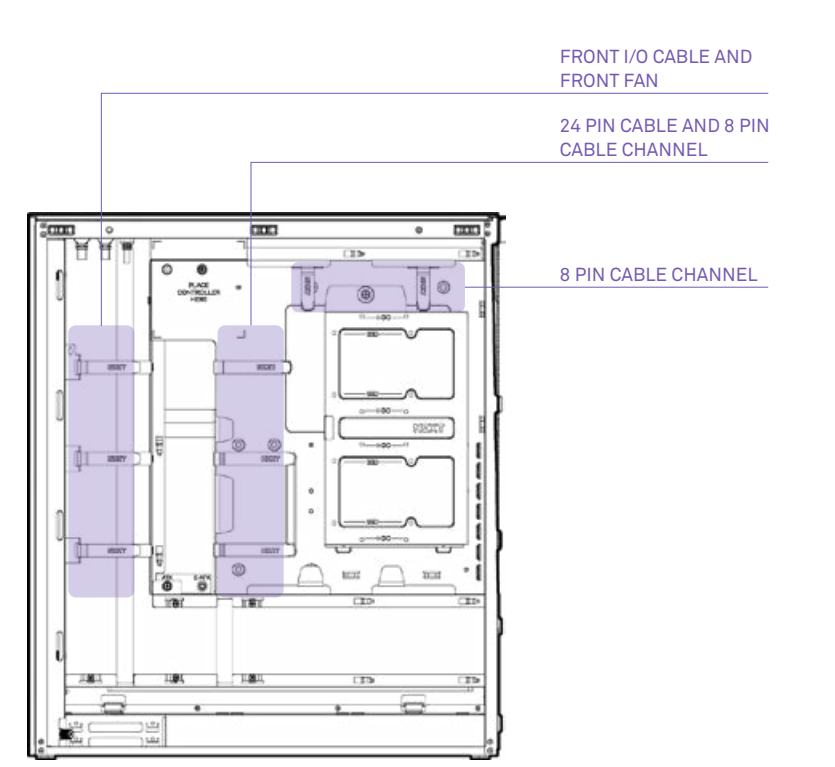

PANEL REMOVAL

EXTRACCIÓN DE PANEL
RETRAIT DU PANNEAU
BLENDE ENTFERNEN
RIMOZIONE DEL PANNELLO
REMOÇÃO DOS PAINÉIS
패널 제거
下面板の取り出し
下面板
移除面板

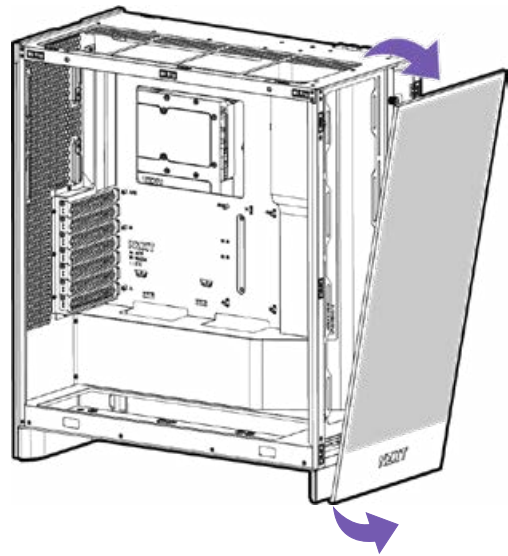
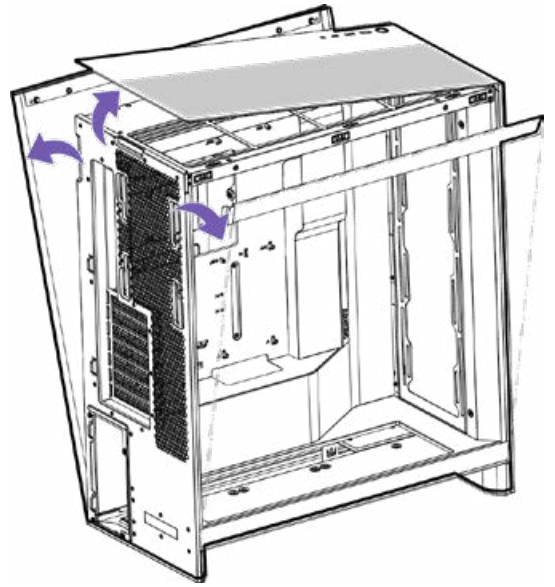

EXPANSION CARD INSTALLATION

INSTALACIÓN DE LA TARJETA DE EXPANSIÓN
INSTALLATION DE LA CARTE D'EXTENSION
INSTALLATION DER ERWEITERUNGSKARTE
INSTALLAZIONE DELLA SCHEDE D'ESPANSIONE
INSTALAÇÃO DA PLACA DE EXPANSÃO
확장 카드 설치
拡張カードの設置
扩展卡安装
擴充卡安裝

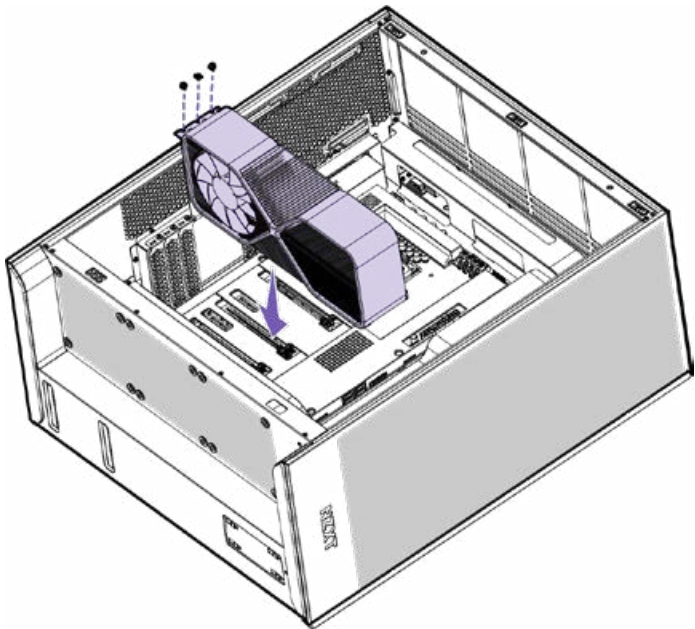

POWER SUPPLY INSTALLATION

INSTALACIÓN DE LA FUENTE DE ALIMENTACIÓN
INSTALLATION DE L'ALIMENTATION
INSTALLATION DER STROMVERSORGUNG
INSTALLAZIONE DELL'ALIMENTATORE
INSTALAÇÃO DA FONTE DE ALIMENTAÇÃO
전원 공급 장치 설치
電源の設置
电源安装
電源安裝

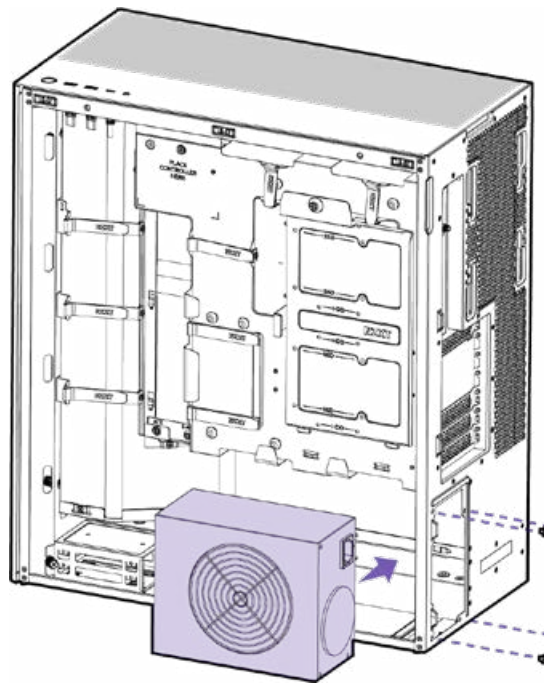

限用物质及元素列表 / 限用物質及元素清單

产品名称: 机箱 · 型號 (型式) : CA-2301, CA-2304						
有害物質及其化學符号						
部件名称	鉛(Pb)	銅(Cu)	汞(Hg)	六价鉻(Cr ^{VI})	多溴联苯(PBB)	多溴联苯醚(PBDE)
外壳	○	○	○	○	○	○
线材	○	○	○	○	○	○
主板/机箱	○	○	○	○	○	○
变压器/线圈	○	○	○	○	○	○
塑料零件	○	○	○	○	○	○

本表格依据SJ/T 11364的规定编制。
○: 表示该有害物质在该部件所有均质材料中的含量均在GB/T 26572规定的限量要求下。
X: 表示该有害物质至少在该部件的某一均质材料中的含量超出GB/T 26572规定的限量要求, 虽然该部件仍符合欧盟指令 2011/65/EU 的规格。

產品名稱: 機箱, 型號 (型式) : CA-2301, CA-2304						
限用物質及其化學符号						
單元	鉛(Pb)	銅(Cu)	汞(Hg)	六價鉻(Cr ^{VI})	多溴聯苯(PBB)	多溴聯苯醚(PBDE)
外殼	○	○	○	○	○	○
線材	○	○	○	○	○	○
主機板	○	○	○	○	○	○
變壓器/線圈	○	○	○	○	○	○
塑膠零件	○	○	○	○	○	○

備考1: "超出0.1wt%"及"超出0.01wt%"係指限用物質之百分比含量超出百分比含量標準。
備考2: "○"係指該限用物質之百分比含量未超出百分比含量標準。
備考3: "X"係指該限用物質為限制項目。

REGULATORY STATEMENT



UKCA DECLARATION OF CONFORMITY
The object of the declaration described above is in conformity with the relevant UK harmonization legislation:
• Electromagnetic Compatibility Regulations 2016
• Electrical Equipment (Safety) Regulations 2016
• The Restriction of the Use of Certain Hazardous Substances in Electrical and Electronic Equipment Regulations 2012

ROHS STATEMENT
This product is compliant to implement RoHS (Restriction of Hazardous Substances) type regulations worldwide, including but not limited to China, India, Japan, Korea and European Union.

REACH STATEMENT
EU REACH SVHC Disclosure on Candidate List
REACH (Registration, Evaluation, Authorization and Restriction of Chemicals, EC 1907/2006) is the European Union's (EU) chemical substances regulatory framework. REACH requires NZXT Inc. to provide customers with sufficient information on Substance of Very High Concern (SVHC) contained in products in concentration above 0.1% weight by weight (w/w) to allow safe use of the product.

DECLARATION OF CONFORMITY
The device complies with the requirements set out in the Council Directives relevant Union harmonisation legislation:
• EMC Directive 2014/30/EU
• RoHS Directive 2011/65/EU & (EU) 2015/863

DECLARATION OF CONFORMITÉ
L'appareil est conforme aux exigences définies dans les directives du Conseil relatives à la législation d'harmonisation de l'Union:
• Directive EMC 2014/30/UE
• Directive RoHS 2011/65/UE et (UE) 2015/863

DECLARACIÓN DE CONFORMIDAD
El dispositivo cumple los requisitos impuestos en las directivas del Consejo relativas a la legislación de armonización de la Unión Europea:
• Directiva sobre compatibilidad electromagnética 2014/30/UE
• Directiva sobre sustancias peligrosas 2011/65/UE (UE) 2015/863

DICHIARAZIONE DI CONFORMITÀ
Il dispositivo è conforme con i requisiti definiti nelle Direttive del Consiglio relative alla Norma sull'armonizzazione dell'Unione:
• Direttiva EMC 2014/30/UE
• Direttiva RoHS 2011/65/UE e (UE) 2015/863

CABLE BAR

BARRA PARA CABLES
BARRÉ DE CÂBLAGE
KABELSCHIENE
BARRA DEI CAVI
BARRA DE CABOS
케이블 배
ケーブルバー
插接板
繫線板

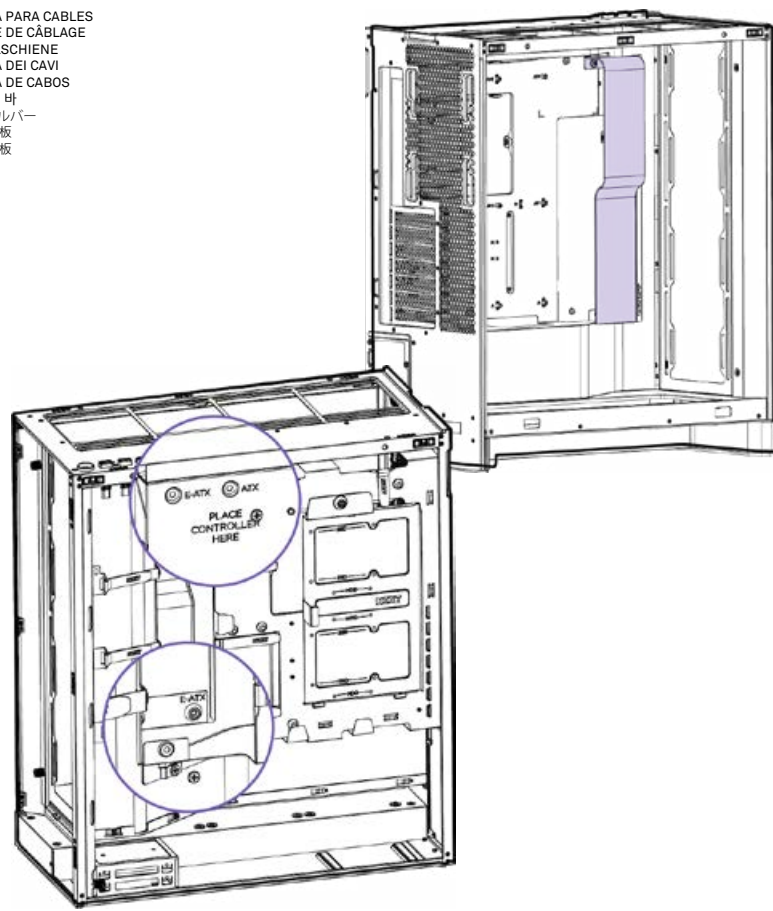

MOTHERBOARD INSTALLATION

INSTALACIÓN DE LA PLACA BASE
INSTALLATION DE LA CARTE MÈRE
INSTALLATION DER HAUPTPLATINE
INSTALLAZIONE DELLA SCHEDE MADRE
INSTALAÇÃO DA PLACA PRINCIPAL
메인보드 설치
マザーボードの設置
主板安裝
主機板安裝

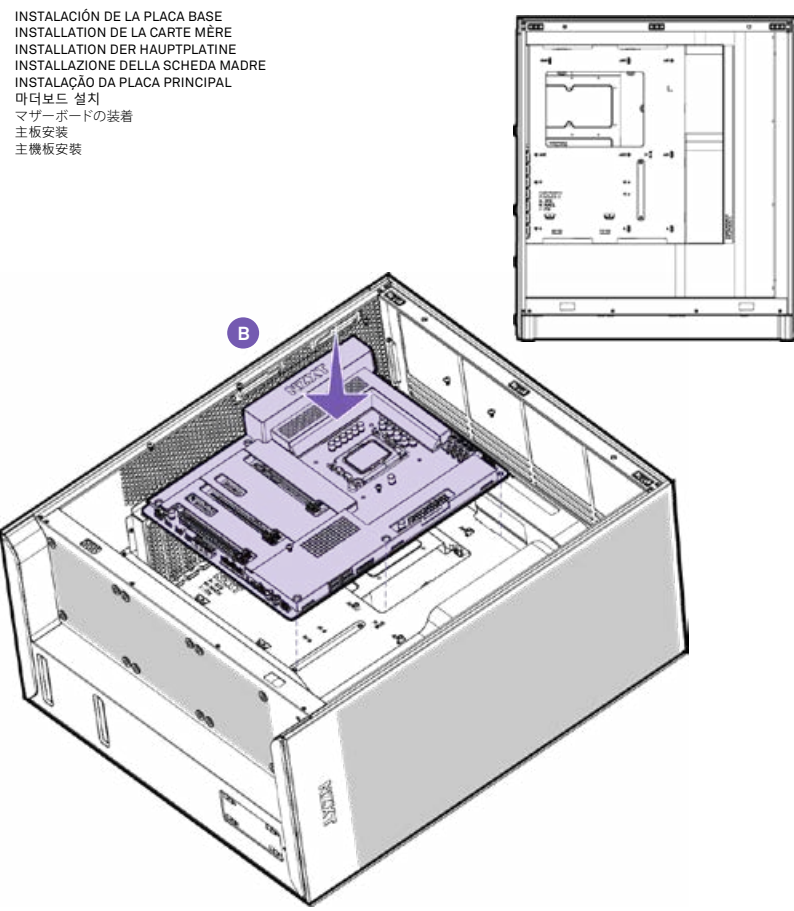

SSD DRIVE INSTALLATION

INSTALACIÓN DE LA UNIDAD DE DISCO DE ESTADO SÓLIDO
INSTALLATION DU DISQUE SSD
SSD-LAUFWERKINSTALLATION
INSTALLAZIONE DELL'UNITÀ SSD
INSTALAÇÃO DA PLACA DE EXPANSÃO
메인보드 설치
SSD装着
SSD 固态硬盘安裝
SSD安裝

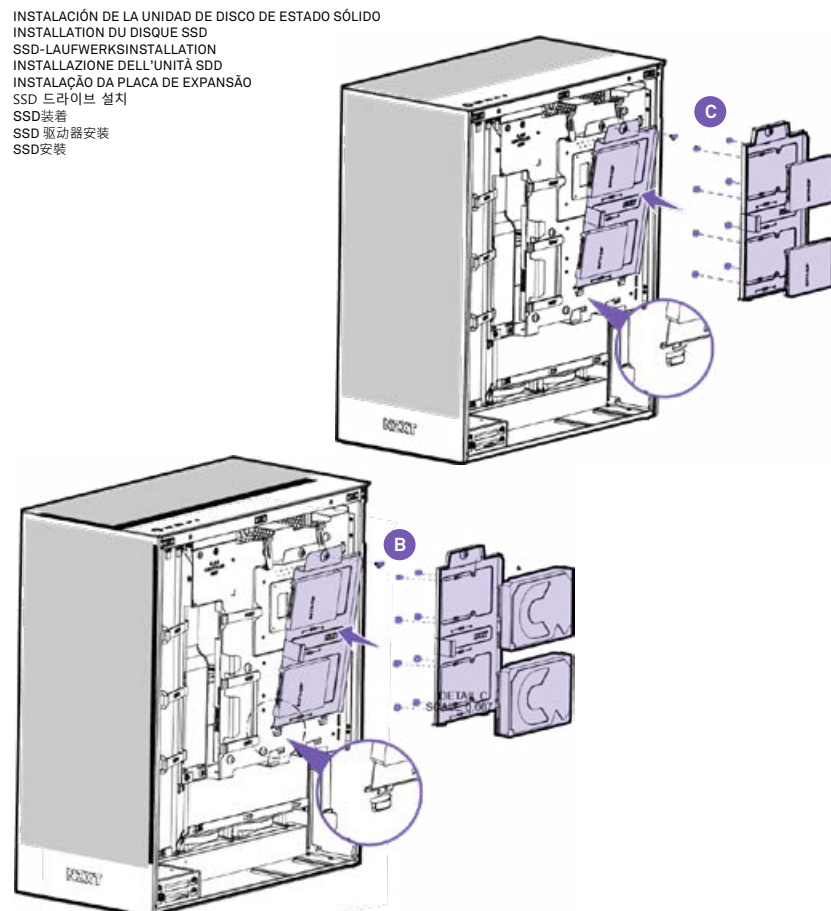

HDD DRIVE INSTALLATION

INSTALACIÓN DE LA UNIDAD DE DISCO DURO
INSTALLATION DE LECTEUR HDD
HDD-LAUFWERKINSTALLATION
INSTALLAZIONE DELL'UNITÀ HDD
INSTALAÇÃO DA PLACA DE EXPANSÃO
HDD 드라이브 설치
HDD装着
HDD 硬盘安装
硬盤安裝

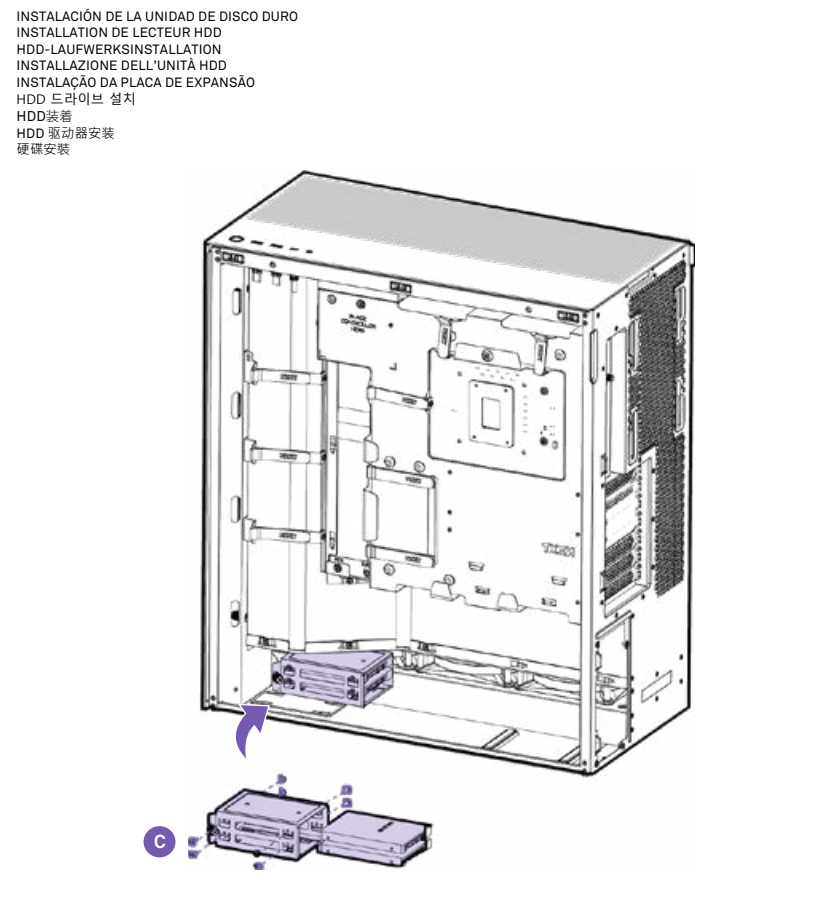

EXPANSION CARD INSTALLATION

INSTALACIÓN DE LA FUENTE DE ALIMENTACIÓN
INSTALLATION DE L'ALIMENTATION
INSTALLATION DER STROMVERSORGUNG
INSTALLAZIONE DELL'ALIMENTATORE
INSTALAÇÃO DA FONTE DE ALIMENTAÇÃO
전원 공급 장치 설치
電源の設置
电源安装
電源安裝

POWER SUPPLY INSTALLATION

COMPATIBILIDAD DE VENTILADORES Y RADIADORES
PRISE EN CHARGE DES RADIATEURS ET VENTILATEURS
LÜFTER- UND KÜHLER-UNTERSTÜTZUNG
SUPPORTO VENTOLE E RADIATORE
SUPORTE PARA VENTONINHA E A RADIADOR
팬 및 쿨러/레이더 지원
対応ファン/冷却ラジエーター
风扇和散热器支持
風扇和散熱器安裝

FAN & RADIATOR INSTALLATION

120mm
140mm
240mm
280mm
360mm

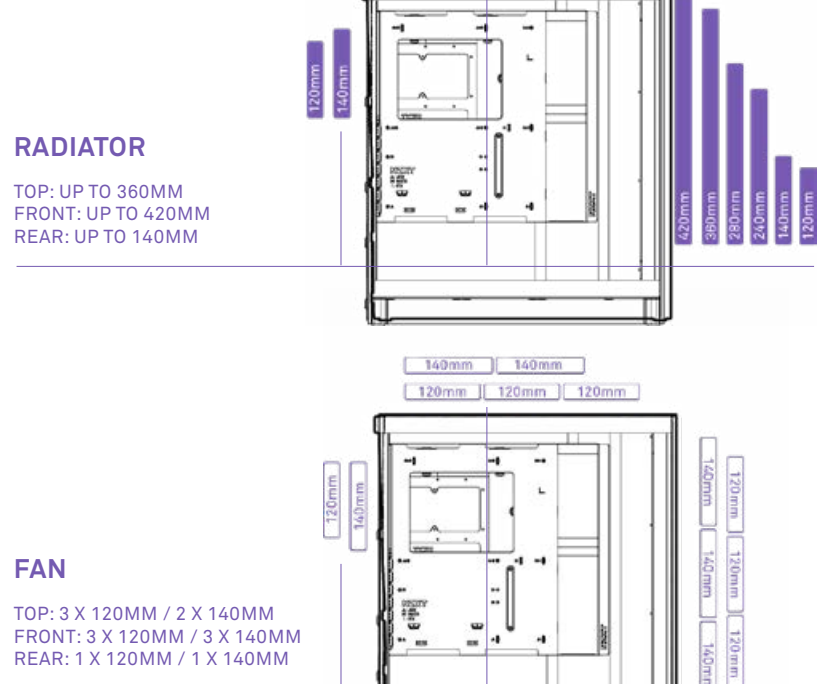

FAN & RADIATOR INSTALLATION

INSTALACIÓN DE VENTILADORES Y RADIADORES
INSTALLATION DES RADIATEURS ET VENTILATEURS
LÜFTER- UND KÜHLER-INSTALLATION
INSTALLAZIONE VENTOLE E RADIATORE
INSTALAÇÃO PARA VENTONINHA E A RADIADOR
팬 및 라디에이터 설치
ファンとラジエーターの取り付け
風扇和散热器安裝
風扇和散熱器安裝

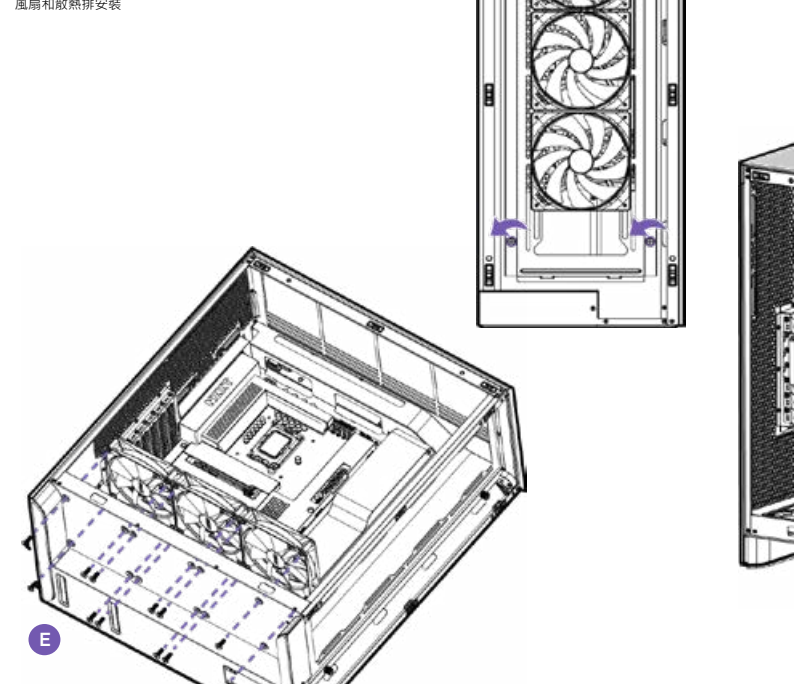

SSD DRIVE INSTALLATION

INSTALACIÓN DE LA UNIDAD DE DISCO DURO
INSTALLATION DE LECTEUR HDD
HDD-LAUFWERKINSTALLATION
INSTALLAZIONE DELL'UNITÀ HDD
INSTALAÇÃO DA PLACA DE EXPANSÃO
HDD 드라이브 설치
HDD装着
HDD 硬盘安装
硬盤安裝

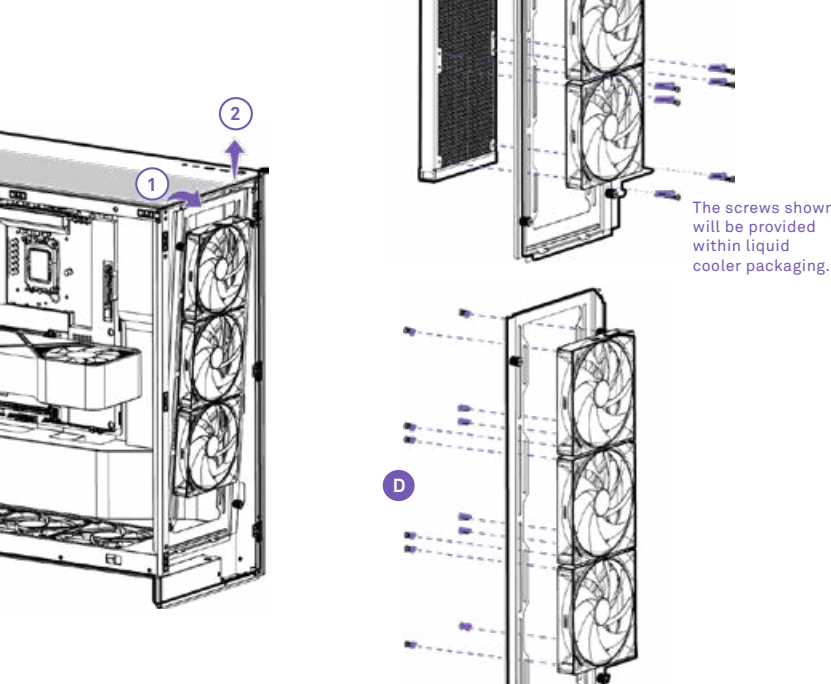

POWERING THE LEDS

CÓMO ALIMENTAR LAS LUCES LED (ARGB 5 V)
ALIMENTATION DES LED (RVBA 5 V)
LEDS ANSCHLIESSEN (SV ARGB)
ALIMENTAZIONE LED (SV ARGB)
ALIMENTAÇÃO DOS LÉDS (ARGB 5V)
LED 전원 키기(SV ARGB)
LEDへの電力供給 (SV ARGB)
为 LED 供电 (SV ARGB)
為 LED 供电 (SV ARGB)

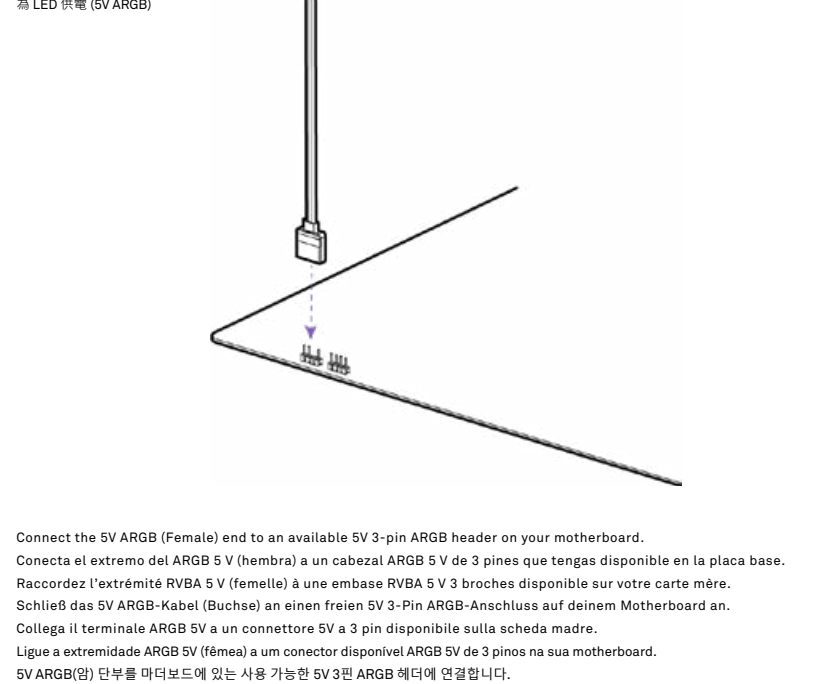

限用物质及元素列表 / 限用物質及元素清單

产品名称: 机箱 · 型號 (型式) : CA-2301, CA-2304						
有害物質及其化學符号						
部件名称	鉛(Pb)	銅(Cu)	汞(Hg)	六价鉻(Cr ^{VI})	多溴联苯(PBB)	多溴联苯醚(PBDE)
外壳	○	○	○	○	○	○
线材	○	○	○	○	○	○
主板/机箱	○	○	○	○	○	○
变压器/线圈	○	○	○	○	○	○
塑料零件	○	○	○	○	○	○

本表格依据SJ/T 11364的规定编制。
○: 表示该有害物质在该部件所有均质材料中的含量均在GB/T 26572规定的限量要求下。
X: 表示该有害物质至少在该部件的某一均质材料中的含量超出GB/T 26572规定的限量要求, 虽然该部件仍符合欧盟指令 2011/65/EU 的规格。

產品名稱: 機箱, 型號 (型式) : CA-2301, CA-2304						
限用物質及其化學符号						
單元	鉛(Pb)	銅(Cu)	汞(Hg)	六價鉻(Cr ^{VI})	多溴聯苯(PBB)	多溴聯苯醚(PBDE)
外殼	○	○	○	○	○	○
線材	○	○	○	○	○	○
主機板	○	○	○	○	○	○
變壓器/線圈	○	○	○	○	○	○
塑膠零件	○	○	○	○	○	○

備考1: "超出0.1wt%"及"超出0.01wt%"係指限用物質之百分比含量超出百分比含量標準。
備考2: "○"係指該限用物質之百分比含量未超出百分比含量標準。
備考3: "X"係指該限用物質為限制項目。

REGULATORY STATEMENT



UKCA DECLARATION OF CONFORMITY
The object of the declaration described above is in conformity with the relevant UK harmonization legislation:
• Electromagnetic Compatibility Regulations 2016
• Electrical Equipment (Safety) Regulations 2016
• The Restriction of the Use of Certain Hazardous Substances in Electrical and Electronic Equipment Regulations 2012

ROHS STATEMENT
This product is compliant to implement RoHS (Restriction of Hazardous Substances) type regulations worldwide, including but not limited to China, India, Japan, Korea and European Union.

REACH STATEMENT
EU REACH SVHC Disclosure on Candidate List
REACH (Registration, Evaluation, Authorization and Restriction of Chemicals, EC 1907/2006) is the European Union's (EU) chemical substances regulatory framework. REACH requires NZXT Inc. to provide customers with sufficient information on Substance of Very High Concern (SVHC) contained in products in concentration above 0.1% weight by weight (w/w) to allow safe use of the product.

DECLARATION OF CONFORMITY
The device complies with the requirements set out in the Council Directives relevant Union harmonisation legislation:
• EMC Directive 2014/30/EU
• RoHS Directive 2011/65/EU & (EU) 2015/863

DECLARATION OF CONFORMITÉ
L'appareil est conforme aux exigences définies dans les directives du Conseil relatives à la législation d'harmonisation de l'Union:
• Directive EMC 2014/30/UE
• Directive RoHS 2011/65/UE et (UE) 2015/863

DECLARACIÓN DE CONFORMIDAD
El dispositivo cumple los requisitos impuestos en las directivas del Consejo relativas a la legislación de armonización de la Unión Europea:
• Directiva sobre compatibilidad electromagnética 2014/30/UE
• Directiva sobre sustancias peligrosas 2011/65/UE (UE) 2015/863

DICHIARAZIONE DI CONFORMITÀ
Il dispositivo è conforme con i requisiti definiti nelle Direttive del Consiglio relative alla Norma sull'armonizzazione dell'Unione:
• Direttiva EMC 2014/30/UE
• Direttiva RoHS 2011/65/UE e (UE) 2015/863

REGULATORY STATEMENT

KONFORMITÄTSEKKLÄRUNG
Das Gerät entspricht den Anforderungen der entsprechenden EU-Harmonisierungsrichtlinien des Rates:
• EMV-Richtlinie 2014/30/EU
• RoHS-Richtlinie 2011/65/EU & (EU) 2015/863

OŚWIADCZENIE ZGODNOŚCI
Urządzenie jest zgodne z wymaganiami określonymi w odpowiednich unijnych Dyrektywach harmonizacyjnych Rady:
• Dyrektywa EMC 2014/30/UE
• Dyrektywa RoHS 2011/65/UE i (UE) 2015/863

KONFORMITÄTSEKKLÄRUNG
Enheten uppfyller kraven som anges i Rådets direktiva relevanta harmoniseringslagstiftning för Europeiska unionen:
• EMC-direktiv 2014/30/EU
• RoHS-direktiv 2011/65/EU & (EU) 2015/863

VERKLARING VAN OVEERENSTEMMING
Het apparaat voldoet aan de vereisten van de relevante richtlijn(en) van de Raad met betrekking tot harmonisatiewetgeving in de Unie:
• EMC-richtlijn 2014/30/EU
• RoHS-richtlijn 2011/65/EU & (EU) 2015/863

To protect the global environment and as an environmentalist, NZXT must remind you that:
Under the European Union ("EU") Directive on Waste Electrical and Electronic Equipment, Directive 2002/96/EC, which takes effect on August 13, 2005, products of "electrical and electronic equipment" cannot be discarded as municipal waste anymore and manufacturers of covered electronic equipment will be obligated to take back such products at the end of their useful life. NZXT will comply with the product take back requirements at the end of life of NZXT-branded products that are sold into the EU. You can return these products to local collection points.

En tant qu'écologiste et afin de protéger l'environnement, NZXT tient à rappeler ceci:
Au sujet de la directive européenne (EU) relative aux déchets des équipements électriques et électroniques, directive 2002/96/EC, prenant effet le 13 août 2005, que les produits électriques et électroniques ne peuvent être déposés dans les décharges ou tout simplement mis à la poubelle. Les fabricants de ces équipements seront obligés de récupérer certains produits en fin de vie. NZXT prend en compte cette exigence relative au retour des produits en fin de vie au sein de la communauté européenne. Par conséquent vous pouvez retourner localement ces matériels dans les points de collecte.

NZXT GLOBAL WARRANTY POLICY

This NZXT Global Warranty Policy governs the sale of products by NZXT to you.

New NZXT Product	Warranty Length for Parts
Computer Cases	2 Years

Any replacement product will be covered under warranty for the remainder of the warranty period or thirty days, whichever is longer. Proof of purchase is required for warranty service.

II. WHO IS PROTECTED
The Warranty covers only NZXT products purchased by the original consumer.

III. WHAT IS AND IS NOT COVERED
Please note that our warranty is not an unconditional guarantee. If the product, in NZXT's reasonable opinion, malfunctions within the warranty period, NZXT will provide you at its sole discretion with a repaired or replacement product, either new or refurbished, with a similar function that is equal or greater in value depending on supply. Our warranty does not cover the following:

- any product or serial number/warranty sticker modification applied without permission from NZXT;
- any damage that is not a manufacturing defect;
- damage, deterioration or malfunction resulting from accident, abuse, misuse, neglect, fire, water, lightning, or other acts of nature, unauthorized product modification or failure to follow instructions included with the product;
- improper installation, unauthorized alterations or modifications, or repair or attempted repair by anyone not authorized by NZXT;
- shipping or transport damage (claims must be made with the carrier);
- normal wear and tear.

NZXT does not warrant that this product will meet your requirements. It is your responsibility to determine the suitability of this product for your purpose. For NZXT Store orders, we cover two way return shipping for all exchanges and returns. For all other authorized dealers, NZXT Support does not cover return shipping and only covers one way shipping from NZXT back to the end user for exchanges. Two way expedited shipping is provided for all PSUs covered under the Less Than Three program, inclusion of purchase location, provided the location is an approved NZXT reseller.

IV. EXCLUSION OF DAMAGES (DISCLAIMER)
NZXT's sole obligation and liability under this warranty is limited to the repair or replacement of a defective product with either a new or refurbished product with a similar function that is equal or greater in value at our option. NZXT shall not, in any event, be liable for any incidental or consequential damage, including but not limited to damages resulting from interruption of service and loss of data, business, or for liability in tort relating to this product or resulting from its use or possession.

V. LIMITATIONS OF IMPLIED WARRANTIES
There are no other warranties, expressed or implied, including but not limited to those of merchantability or fitness for a particular purpose. The duration of implied warranties is limited to the warranty length specified in Paragraph I.

VI. TO OBTAIN TECHNICAL SUPPORT
If you have already referenced your product owner's manual and still need help, you may contact us by phone at +1 (800) 228-9395, by email at service@nzxt.com, or visit the NZXT Support site at nzxt.com/customer-support.

VII. HOW TO OBTAIN A WARRANTY SERVICE FROM NZXT
To receive a warranty service for your product when purchased directly from NZXT, you must submit a request via the NZXT Support site outlining the problem. If a technician deems the product defective or requiring testing, you will be required to provide a copy of your proof of purchase, which will enable you to submit a Return Merchandise Authorization "RMA" request.

NZXT GLOBAL WARRANTY POLICY

This NZXT Global Warranty Policy governs the sale of products by NZXT to you.

I. WARRANTY LENGTH

New NZXT Product	Warranty Length for Parts
Computer Cases	2 Years

Any replacement product will be covered under warranty for the remainder of the warranty period or thirty days, whichever is longer. Proof of purchase is required for warranty service.

II. WHO IS PROTECTED
The Warranty covers only NZXT products purchased by the original consumer.

III. WHAT IS AND IS NOT COVERED
Please note that our warranty is not an unconditional guarantee. If the product, in NZXT's reasonable opinion, malfunctions within the warranty period, NZXT will provide you at its sole discretion with a repaired or replacement product, either new or refurbished, with a similar function that is equal or greater in value depending on supply. Our warranty does not cover the following:

- any product or serial number/warranty sticker modification applied without permission from NZXT;
- any damage that is not a manufacturing defect;
- damage, deterioration or malfunction resulting from accident, abuse, misuse, neglect, fire, water, lightning, or other acts of nature, unauthorized product modification or failure to follow instructions included with the product;
- improper installation, unauthorized alterations or modifications, or repair or attempted repair by anyone not authorized by NZXT;
- shipping or transport damage (claims must be made with the carrier);
- normal wear and tear.

NZXT does not warrant that this product will meet your requirements. It is your responsibility to determine the suitability of this product for your purpose. For NZXT Store orders, we cover two way return shipping for all exchanges and returns. For all other authorized dealers, NZXT Support does not cover return shipping and only covers one way shipping from NZXT back to the end user for exchanges. Two way expedited shipping is provided for all PSUs covered under the Less Than Three program, inclusion of purchase location, provided the location is an approved NZXT reseller.

IV. EXCLUSION OF DAMAGES (DISCLAIMER)
NZXT's sole obligation and liability under this warranty is limited to the repair or replacement of a defective product with either a new or refurbished product with a similar function that is equal or greater in value at our option. NZXT shall not, in any event, be liable for any incidental or consequential damage, including but not limited to damages resulting from interruption of service and loss of data, business, or for liability in tort relating to this product or resulting from its use or possession.

V. LIMITATIONS OF IMPLIED WARRANTIES
There are no other warranties, expressed or implied, including but not limited to those of merchantability or fitness for a particular purpose. The duration of implied warranties is limited to the warranty length specified in Paragraph I.

VI. TO OBTAIN TECHNICAL SUPPORT
If you have already referenced your product owner's manual and still need help, you may contact us by phone at +1 (800) 228-9395, by email at service@nzxt.com, or visit the NZXT Support site at nzxt.com/customer-support.

VII. HOW TO OBTAIN A WARRANTY SERVICE FROM NZXT
To receive a warranty service for your product when purchased directly from NZXT, you must submit a request via the NZXT Support site outlining the problem. If a technician deems the product defective or requiring testing, you will be required to provide a copy of your proof of purchase, which will enable you to submit a Return Merchandise Authorization "RMA" request.

IX. WARRANTY SERVICE FROM RESELLERS
In the event that a warranty service is sought, you must provide proof of purchase (store receipt or invoice) in order to receive the service and if deemed necessary, repair or replacement product.

In the UK:

- If you are a consumer and have your habitual residence in the EU, you additionally enjoy the protection afforded to you by provisions that cannot be derogated from by agreement by virtue of the law where you have your habitual residence.

In Australia:
Within the first 60 days after purchase, please return your product (or for power supplies installed within our enclosures, just the failed power supply) to your dealer or reseller for a replacement. If the product is still within warranty and you can no longer return it to your dealer, please contact NZXT Customer Support (see above) for assistance and instructions. NZXT will not accept returns without prior approval and an RMA number.

In Europe:
Within the first year after purchase, please return your product (or for power supplies installed within our enclosures, just the failed power supply) to your dealer or reseller for a replacement. If the product is still within warranty and you can no longer return it to your dealer, please contact NZXT Customer Support (see above) for assistance and instructions. NZXT will not accept returns without prior approval.

NZXT GLOBAL WARRANTY POLICY

This NZXT Global Warranty Policy governs the sale of products by NZXT to you.

I. WARRANTY LENGTH

New NZXT Product	Warranty Length for Parts
Computer Cases	2 Years

Any replacement product will be covered under warranty for the remainder of the warranty period or thirty days, whichever is longer. Proof of purchase is required for warranty service.

II. WHO IS PROTECTED
The Warranty covers only NZXT products purchased by the original consumer.

III. WHAT IS AND IS NOT COVERED
Please note that our warranty is not an unconditional guarantee. If the product, in NZXT's reasonable opinion, malfunctions within the warranty period, NZXT will provide you at its sole discretion with a repaired or replacement product, either new or refurbished, with a similar function that is equal or greater in value depending on supply. Our warranty does not cover the following:

- any product or serial number/warranty sticker modification applied without permission from NZXT;
- any damage that is not a manufacturing defect;
- damage, deterioration or malfunction resulting from accident, abuse, misuse, neglect, fire, water, lightning, or other acts of nature, unauthorized product modification or failure to follow instructions included with the product;
- improper installation, unauthorized alterations or modifications, or repair or attempted repair by anyone not authorized by NZXT;
- shipping or transport damage (claims must be made with the carrier);
- normal wear and tear.

NZXT does not warrant that this product will meet your requirements. It is your responsibility to determine the suitability of this product for your purpose. For NZXT Store orders, we cover two way return shipping for all exchanges and returns. For all other authorized dealers, NZXT Support does not cover return shipping and only covers one way shipping from NZXT back to the end user for exchanges. Two way expedited shipping is provided for all PSUs covered under the Less Than Three program, inclusion of purchase location, provided the location is an approved NZXT reseller.

IV. EXCLUSION OF DAMAGES (DISCLAIMER)
NZXT's sole obligation and liability under this warranty is limited to the repair or replacement of a defective product with either a new or refurbished product with a similar function that is equal or greater in value at our option. NZXT shall not, in any event, be liable for any incidental or consequential damage, including but not limited to damages resulting from interruption of service and loss of data, business, or for liability in tort relating to this product or resulting from its use or possession.

V. LIMITATIONS OF IMPLIED WARRANTIES
There are no other warranties, expressed or implied, including but not limited to those of merchantability or fitness for a particular purpose. The duration of implied warranties is limited to the warranty length specified in Paragraph I.

VI. TO OBTAIN TECHNICAL SUPPORT
If you have already referenced your product owner's manual and still need help, you may contact us by phone at +1 (800) 228-9395, by email at service@nzxt.com, or visit the NZXT Support site at nzxt.com/customer-support.

VII. HOW TO OBTAIN A WARRANTY SERVICE FROM NZXT
To receive a warranty service for your product when purchased directly from NZXT, you must submit a request via the NZXT Support site outlining the problem. If a technician deems the product defective or requiring testing, you will be required to provide a copy of your proof of purchase, which will enable you to submit a Return Merchandise Authorization "RMA" request.

IX. WARRANTY SERVICE FROM RESELLERS
In the event that a warranty service is sought, you must provide proof of purchase (store receipt or invoice) in order to receive the service and if deemed necessary, repair or replacement product.

In the UK:

- If you are a consumer and have your habitual residence in the EU, you additionally enjoy the protection afforded to you by provisions that cannot be derogated from by agreement by virtue of the law where you have your habitual residence.

In Australia:
Within the first 60 days after purchase, please return your product (or for power supplies installed within our enclosures, just the failed power supply) to your dealer or reseller for a replacement. If the product is still within warranty and you can no longer return it to your dealer, please contact NZXT Customer Support (see above) for assistance and instructions. NZXT will not accept returns without prior approval and an RMA number.

In Europe:
Within the first year after purchase, please return your product (or for power supplies installed within our enclosures, just the failed power supply) to your dealer or reseller for a replacement. If the product is still within warranty and you can no longer return it to your dealer, please contact NZXT Customer Support (see above) for assistance and instructions. NZXT will not accept returns without prior approval.

