

QUICK START GUIDE

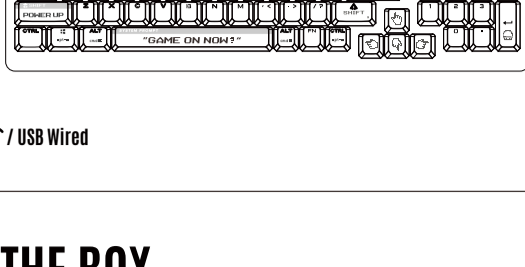

Bluetooth / 2.4G / USB Wired



WHAT'S IN THE BOX

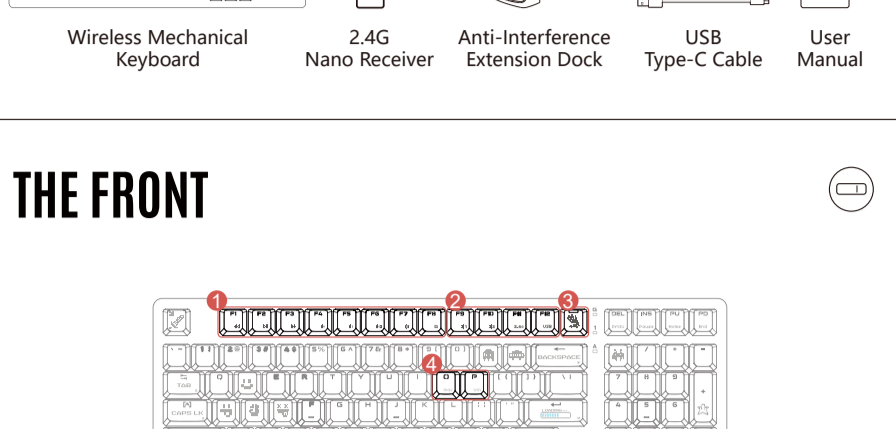

THE FRONT



- 1 FN Multimedia Hotkeys
- 2 Multi-Device Switch
- 3 Lighting Effects Switching
- 4 Operating System Swap
- 5 PC/MAC Dual-Function Keys

THE BOTTOM

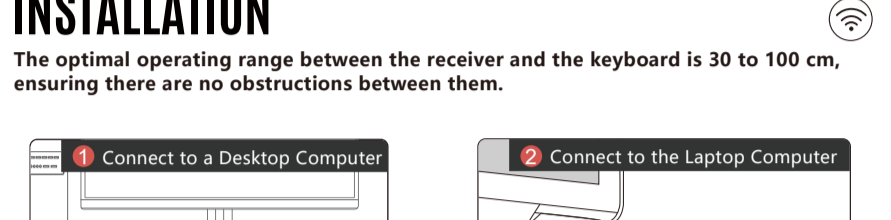

The optimal operating range between the receiver and the keyboard is 30 to 100 cm, ensuring there are no obstructions between them.

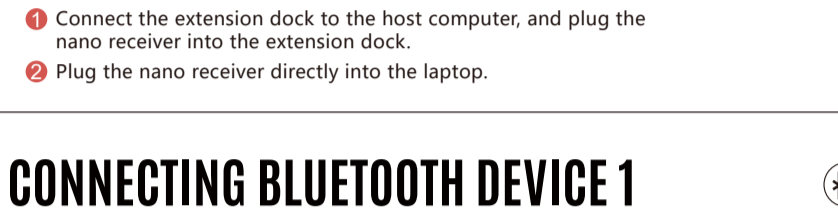

- 1 Connect the extension dock to the host computer, and plug the nano receiver into the extension dock.
- 2 Plug the nano receiver directly into the laptop.

CONNECTING BLUETOOTH DEVICE 1

(For Mobile Phone/Tablet/Laptop)

- 1 First Pairing: Short Press [Fn+F9]
- 2 F9 Key Flash Light
- 3 Choose [WS98] from your Bluetooth device.
- 4 11 The F9 key will light up for a while then light off after the keyboard is connected.

Note: To re-enter pairing mode, long press "Fn + F9" for 3 seconds.

CONNECTING BLUETOOTH DEVICE 2

(For Mobile Phone/Tablet/Laptop)

- 1 First Pairing: Short Press [Fn+F10]
- 2 F10 Key Flash Light
- 3 Choose [WS98] from your Bluetooth device.
- 4 12 The F10 key will light up for a while then light off after the keyboard is connected.

Note: To re-enter pairing mode, long press "Fn + F10" for 3 seconds.

CONNECTING 2.4G DEVICE

- 1 Insert the nano receiver into your computer's USB port.
- 2 Turn on the keyboard power switch.
- 3 The F11 key will light up for 10 seconds, indicating that the 2.4G device is connected.

Note: The factory default mode is 2.4G. If the keyboard does not function, press "Fn + F11" to activate the 2.4G mode.

CONNECTING USB DEVICE

Note: While in wired mode, the keyboard charges simultaneously.

- 1 Attach the Type-C end to the keyboard and the USB end to your computer.
- 2 Press "Fn + F12" to change to wired connection mode.
- 3 The F12 key will light up for 10 seconds, indicating that the USB device is connected.

INDICATOR (For Mobile Phone/Tablet/Laptop)

| Device Indicator | F9 Key Flash Light | F10 Key Flash Light | F11 Key Flash Light | F12 Key Flash Light |
|-----------------------------------|----------------------------|----------------------------|----------------------------|----------------------------|
| Multi-Device Switch | FN + F9 | FN + F10 | FN + F11 | FN + F12 |
| Device Switch: Short-Press for 1S | F9 Solid Light 10S | F10 Solid Light 10S | F11 Solid Light 10S | F12 Solid Light 10S |
| First Pair: Automatic Pairing | Pairing: Flashes Slowly | Connected: Solid Light 10S | No Need to Pair | Pairing: Flashes Slowly |
| Re-Pair: Short-Press for 3S | Connected: Solid Light 10S | Connected: Solid Light 10S | Connected: Solid Light 10S | Connected: Solid Light 10S |

COMBINATION FN KEYS

Multimedia Hotkeys

FN + F1: Previous | FN + F2: Play/Pause | FN + F3: Next | FN + F4: Mute | FN + F5: Volume- | FN + F6: Volume+ | FN + F7: Lighting Effect

Other FN Shortcuts Switch

FN + F8: PrintScreen | FN + F9: Pause | FN + F10: Home | FN + F11: End | FN + F12: Brightness+ / Brightness- | FN + F13: Menu | FN + F14: Scroll Lock

FN Multi-Device Switch

FN + F15: Bluetooth Device 1 | FN + F16: Bluetooth Device 2 | FN + F17: 2.4G | FN + F18: USB Wired

Operating System Swap

FN + O: Mac System | FN + P: Windows System

Disable "Windows" Key

FN + Win: *The G LED Lights Up in Solid Red

DUAL-FUNCTION KEY Win / Mac Layout

| Keyboard Layout | Windows | Mac |
|-----------------|------------|-----------|
| FN + O | Ctrl | Control ^ |
| FN + Win | Start | Option |
| FN + ALT | Alt | Command |
| FN + ALT | Alt-Right | Command |
| FN + CTRL | Ctrl-Right | Option |

Switching Steps:
 ① Choose Mac layout by pressing "Fn + O".
 ② Choose PC layout by pressing "Fn + P".

HOW TO CONFIRM CURRENT DEVICE

After turning on the computer or restarting the keyboard, the F9~F12 keys will light up to show the currently connected devices.

| Keypads | F9 | F10 | F11 | F12 |
|-----------------|--|--------------------|-------------|-----------|
| Status | 1 | 2 | 2.4G | USB |
| Connection Mode | Bluetooth Device 1 | Bluetooth Device 2 | 2.4G Device | USB Wired |
| Connecting | F9~F12 Key Solid Light 10S | | | |
| Connected | F9~F12 Key Restore RGB Lighting Effect | | | |

WIRELESS K-ESPORT EDITOR

Provide the keyboard with simple combination settings and programming functions. Players can optimize the most suitable game configuration by key lighting and combination macros, then save it to the keyboard on-board memory.



Download Link: <https://www.bloody.com/en/download.php>

CHARGING/LOW BATTERY INDICATOR

- Low Battery Indicator/Charging**
 - Flash Red: Low Battery Indicator
 - Solid Red: Charging
 - No Light: Fully Charged
 - ≤10H Charging Time
- Wireless Playback Time**
 - Light On: about 80 Hours
 - Light Off: about 666 Hours

*Flashing red light indicates when the battery is below 15%.

Note: While the keyboard is connected with Bluetooth or 2.4G wireless mode, if you plug in the Type-C cable to the keyboard, the wired mode is for charging only. The keyboard will not automatically switch to wired mode.

SWAP SWITCH STEP

Compatible with 3-Pin & 5-Pin Style Mechanical Switches

- Remove Keycaps:** Use the keycap puller to remove the keycaps.
- Remove Switches:** Use the switch puller to remove the switches.
- Align Switch Pins:** Line up the switch pins with the PCB socket.
- Place the Switch:** Insert the switch into the PCB and secure it.
- Press the Switch:** Gently press the switch into place.
- Replace Keycaps:** Put the keycaps back on the keyboard and test it.

Note: The switches, keycap & switch puller pictures are for reference only and are not included in the package.

Q & A

Question: When connected in 2.4G wireless mode, the keyboard sometimes lags. How can I fix this?

Answer: Follow these steps to troubleshoot:
 1. Ensure the receiver is inserted in the USB anti-interference cable seat.
 2. Ensure the wireless environment is within 30~100 cm, with no obstacles or metal objects.
 3. Check for strong wireless routers or other wireless transmitter interference sources within 1 meter.

Question: Is there a maximum number of wireless products that can be used in the same environment?

Answer: We recommend 10 units or less. (For more than 10 units, it is recommended to be 1.5m~3m apart)

Question: Does the keyboard support Win/Mac platforms and also Android and iOS platforms?

Answer: Yes, the layout of the Android platform is the same as the Win platform, and the layout of the iOS platform is the same as the Mac platform.

Question: Can the keyboard layout be remembered?

Answer: Yes, the layout you used last time will be remembered.

Question: Does the keyboard remember the connected device?

Answer: Yes, the device you connected last time will be remembered.

Question: Will my Bluetooth device be disconnected if I plug in USB wired cable when using Bluetooth mode?

Answer: No, multi-mode devices need to be switched manually.

TECH SPEC

| | |
|-----------------------------------|--|
| Connection: | Bluetooth / 2.4G / Wired |
| Operating Range: | 5-10 M |
| Bluetooth Version: | Bluetooth v5.1 |
| Multi-Device: | 4 Devices (Bluetoothx2, 2.4Gx1, USBx1) |
| Layout: | Windows Mac |
| Battery: | 3.7V / 400mAh |
| Battery Life: | 666H (Light Off) / 80H (Light On) |
| BLMS Red Plus Switch: | Linear, Light, Smooth |
| Switch Lifetime: | 50 Million Keystrokes |
| Size: | 38.8 x 13.8 x 4.1 cm |
| Weight: | 995g (w/ cable), 885g (w/o cable) |
| Type-C Cable Length: | 180 cm |
| Anti-Interference Extension Dock: | 120 cm |
| System Requirements: | Windows 7/8/8.1/10/11 |

WARNING STATEMENT

- The following actions may cause damage to the product:
- Disassembling, bumping, crushing, or throwing into the fire can cause irreparable damage due to lithium battery leakage.
 - Avoid exposing to strong sunlight.
 - Follow local laws for battery disposal; recycle if possible. Improper disposal may cause fire or explosion.
 - Avoid charging in environments below 0°C.
 - Do not remove or replace the battery.
 - Do not use chargers with outputs from 6V to 24V. Use a 5V charger to avoid damage.

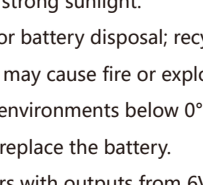

www.Bloody.com

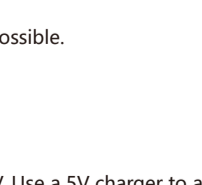

Scan for E-Manual