

In the box

**A + B** IE 100 PRO Wireless (Model: SEBT1)

Soft pouch

IE 100 PRO

IE PRO BT Connector (Model: SEBT1)

Safety Guide

Quick Guide

Compliance Sheet

Black cable for IE 100 PRO

Silicone adapters (L, M, S)

Cleaning tool

Foam adapters (M)

USB-A

USB-C

**A** IE 100 PRO

Soft pouch

IE 100 PRO

Foam adapters (M)

Silicone adapters (L, M, S)

Cleaning tool

Safety Guide

Quick Guide

Compliance Sheet

**B** IE PRO Bluetooth Connector (Model: SEBT1)

IE PRO BT Connector

USB-A

USB-C

Safety Guide

Quick Guide

Compliance Sheet



**IE 100 PRO Wireless**  
Model: SEBT 1



[www.sennheiser.com/download](http://www.sennheiser.com/download)

Sennheiser electronic SE & Co. KG  
Am Labor 1, 30900 Wedemark, Germany  
[www.sennheiser.com](http://www.sennheiser.com)

Publ. 03/24, 587443/A04

**SENNHEISER**

- |                             |                    |
|-----------------------------|--------------------|
| Quick Guide                 | Kort vejledning    |
| Kurzanleitung               | Pikaohje           |
| Guide de démarrage rapide   | Σύντομες οδηγίες   |
| Guía rápida                 | Kısa Kılavuz       |
| Instrucciones resumidas     | Краткая инструкция |
| Instruções resumidas        | 快速指南               |
| Beknopte gebruiksaanwijzing | 快速使用指南             |
| Krótko instrukcja obsługi   | クイックガイド            |
| Snabbguide                  | 요약 안내서             |

**Charging with BT Connector**

100%  
1,5 HRS

USB-C

USB-A

**Switching the headphones on/off**

Hold 3s

ON

OFF

3x "Power on"

3x "Power off"

3x "Connected"

1x "Lost connection"

**Replacing the ear adapters**

Silicone adapters (L, S)

1x CLICK!

2x CLICK!

**Wearing the earphones**

**Bluetooth pairing**

1. Power OFF, Bluetooth OFF

2. Power ON, Bluetooth ON

3. "Pairing"

4. "Pairing successful", "Device (1) connected"

**Changing the cable**

Left

Right

Optimum cable routing

IE PRO BT Connector

Music functions

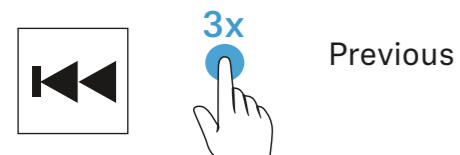
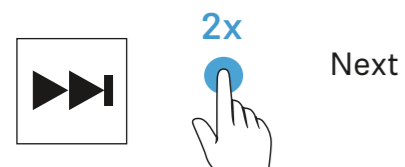
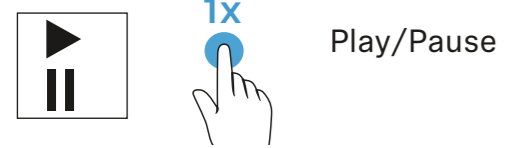

Adjusting the volume

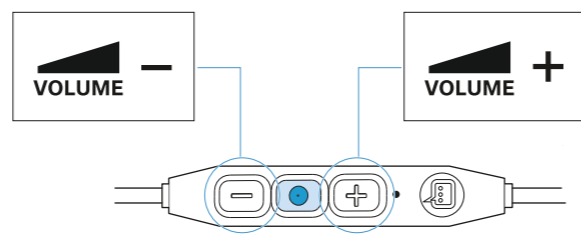

Voice assistant

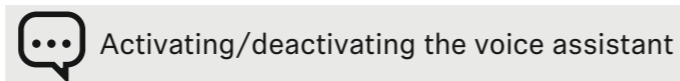
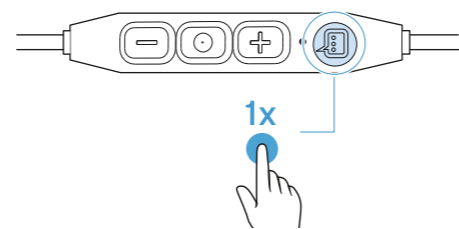

Cleaning

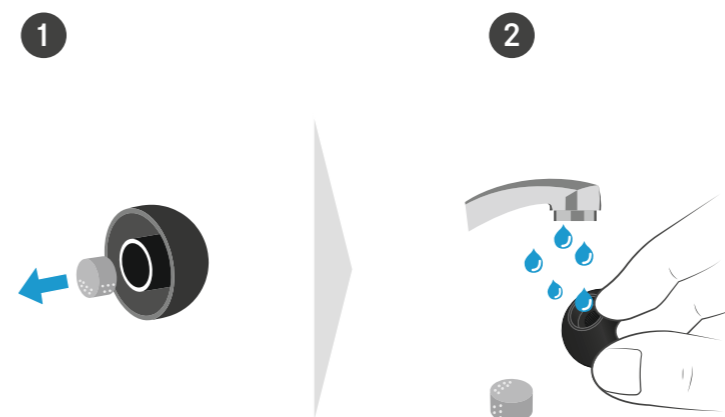

Apple®, iPad® and iPhone® are trademarks of Apple Inc., registered in the U.S. and other countries. Google Play and the Google Play logo are trademarks of Google LLC.

[Information and Accessories](http://www.sennheiser.com)

[www.sennheiser.com](http://www.sennheiser.com)

Call functions

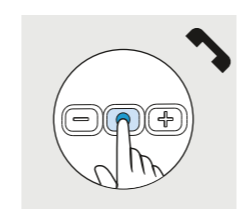
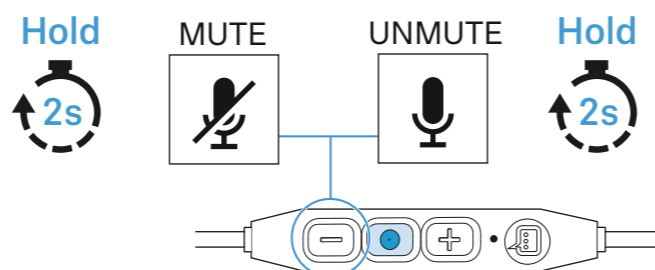
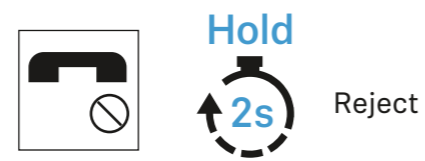
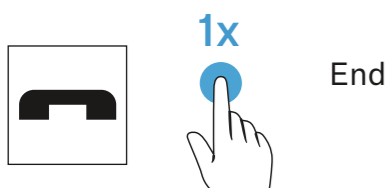
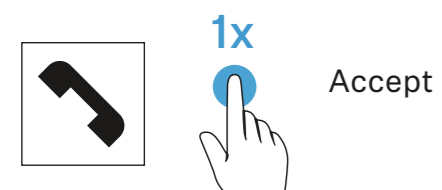

Specifications

Model: IE 100 PRO

Frequency response	20 Hz - 18,000 Hz
Impedance	20 Ω
Sound pressure level (SPL)	115 dB (1 kHz / 1 V <sub>rms</sub> )
Total harmonic distortion (THD)	< 0.1 % (1 kHz, 94 B)
Noise attenuation	< 26 dB
Magnetized field strength	1.63 mT
Temperature range	
Operation	-5 °C ... +50 °C
Storage	-20 °C ... +70 °C
Relative air humidity	< 95 %

Model: SEBT1

Bluetooth®

Version	Bluetooth 5.0 compatible, class 1, BLE
Transmission frequency	2,402 Mhz to 2,480 MHz
Modulation	GFSK, π/4 DQPSK, 8DPSK
Profiles	HSP, HFP, AVRCP, A2DP
Output power	10 mW (max)
Codec	SBC, aptX®, aptX® LL, AAC

The Bluetooth® word mark and logos are registered trademarks owned by Bluetooth SIG, Inc. and any use of such marks by Sennheiser electronic SE & Co. KG is under license.

Model: SEBT1

Wearing style	Bluetooth® neckband cable
Microphone principle	MEMS
Microphone frequency response	100 Hz - 8,000 Hz
Microphone sensitivity	(as per ITU-T P.79) -42 dBV/Pa
Microphone pick-up pattern (speech audio)	omni-directional
Power supply built-in rechargeable lithium-polymer battery	3.7 V ≈, 100 mAh
USB charging	5 V ≈, 100 mA max.
Operating time	10 hrs (music playback via SBC) with rechargeable battery; 240 hrs in standby mode
Charging time of rechargeable batteries	approx. 2.5 hrs
Temperature range	
Operation	+5 °C ... +40 °C ± 5 °C
Charging	+10 °C ... +40 °C ± 5 °C
Storage	-20 °C ... +70 °C
Temperature range	
Operation	10 ... 80 %, non-condensing
Storage	10 ... 90 %
Magnetic field strength	1.63 mT (with IE 100 PRO) 0.23 mT (without headphone)
Weight	approx. 13 g